

FORM A - AREA SURVEY

MASSACHUSETTS HISTORICAL COMMISSION
Office of the Secretary, State House, Boston

Form numbers in this area 101-124	Area no. C
--------------------------------------	---------------

2. Photo (3x3" or 3x5")
Staple to left side of form
Photo number _____

1. Town Livingston

Name of area (if any) Hancock -

Clarke Area

3. General date or period _____

4. Is area uniform (explain):
in style? _____

in condition? _____

in type of ownership? _____

in use? _____

5. Map. Use space below to draw a general map of the area involved. Indicate any historic properties for which individual reports are completed on Forms B thru F, using corresponding numbers. Show street names (including route numbers, if any) and indicate north. Indicate with an "x" existing houses not inventoried on Form B.

see town engineer map.

DO NOT WRITE IN THIS SPACE USGS Quadrant _____ MHC Photo no. _____
--

6. Recorded by _____

Organization _____

Date _____

(over)

7. Historical data. Explain the historical/architectural importance of this area.

8. Bibliography and/or references such as local histories, deeds, assessor's records, early maps, etc.

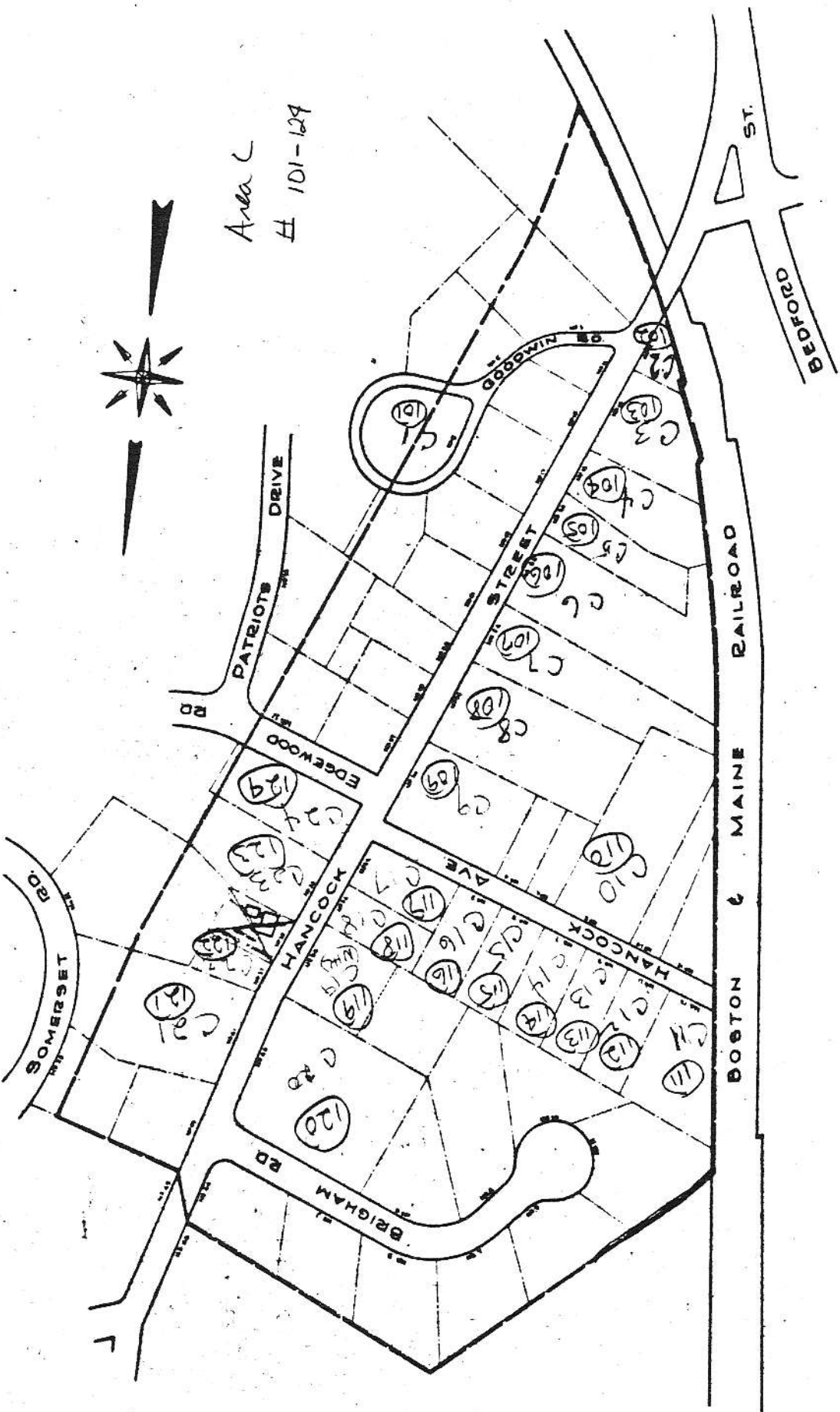

HANCOCK-CLARKE HISTORIC DISTRICT

LEXINGTON, MASS.

SCALE 1"=200'

MARCH 1966

John J. Schmid
TOWN ENGINEER