

# FORM B – BUILDING

MASSACHUSETTS HISTORICAL COMMISSION  
MASSACHUSETTS ARCHIVES BUILDING  
220 MORRISSEY BOULEVARD  
BOSTON, MASSACHUSETTS 02125

Assessor's Number    USGS Quad    Area(s)    Form Number

50/40	Boston North		
-------	--------------	--	--

**Town:**                    Lexington

**Place:** *(neighborhood or village)*

## Photograph



**Address:**                3 Audubon Road

**Historic Name:**        Robinson House

**Uses:** Present:        residential

                                  Original:        residential

**Date of Construction:**    c.1910

**Source:**                 directories

**Style/Form:**             Craftsman

**Architect/Builder:**     unknown

## Exterior Material:

Foundation:        stone

Wall/Trim:         wood shingle/wood

Roof:                 asphalt shingle

**Outbuildings/Secondary Structures:**  
garage

## Major Alterations *(with dates):*

Date? – new windows, porch posts?

## Topographic or Assessor's Map

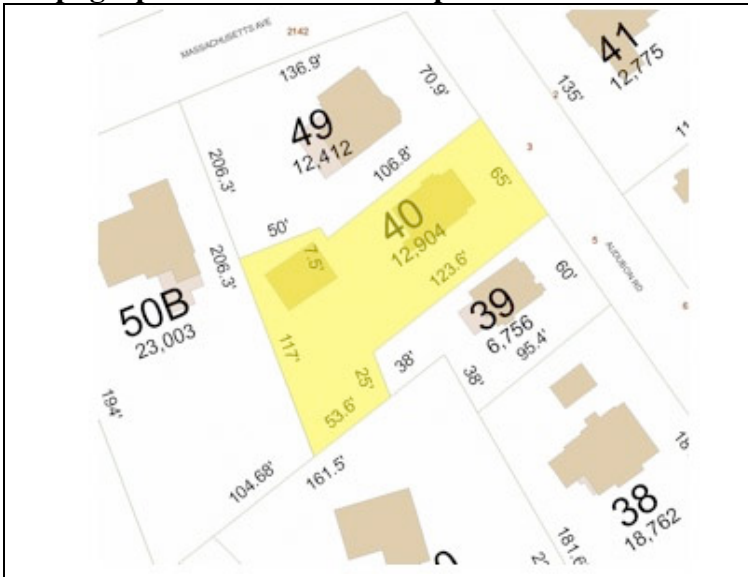

**Condition:**             good

**Moved:** no | x | yes | |    **Date** \_\_\_\_\_

**Acreage:**                0.30 acre

**Setting:**                 residential neighborhood

**Recorded by:**        Lisa Mausolf

**Organization:**        Lexington Historical Commission

**Date** *(month / year)*:    May 2008

# INVENTORY FORM B CONTINUATION SHEET

LEXINGTON

3 AUDUBON ROAD

MASSACHUSETTS HISTORICAL COMMISSION

220 MORRISSEY BOULEVARD, BOSTON, MASSACHUSETTS 02125

Area(s) Form No.

--	--

Recommended for listing in the National Register of Historic Places.

*If checked, you must attach a completed National Register Criteria Statement form.*

## ARCHITECTURAL DESCRIPTION:

*Describe architectural features. Evaluate the characteristics of this building in terms of other buildings within the community.*

The 2 ½-story, gablefront house at 3 Audubon Road is a simple variation on the Craftsman style, displaying a wood-shingled exterior, projecting bargeboard and overhanging eaves with exposed rafter tails on the lateral eaves. The porch is fronted by a single-story porch supported by square (replacement?) posts with a smaller shed-roofed porch with thinner posts on the north side which retains its original glass-and-panel door. With the exception of the pair of double-hung 6/1 windows lighting the attic all of the original windows have been replaced by 1/1 sash which are present in a mix of individual and paired units with a single-story, three-sided bay window projecting from the south elevation.

The driveway extending to the north of the house terminates at a wood-shingled garage with two modern overhead doors on the gablefront and exposed rafter tails on the side elevations.

## HISTORICAL NARRATIVE

*Discuss the history of the building. Explain its associations with local (or state) history. Include uses of the building, and the role(s) the owners/occupants played within the community.*

This property stands on part of the land subdivided by Augustus Scott (see 277 Waltham Street, MHC #461) in 1903. The first known owner was Alfred Robinson of the Breck-Robinson Nursery, who was living here in 1915. By 1918 it was owned by his son, Vernon, who lived here with his bride Irene. Vernon was the proprietor of a trucking business and the couple was still living here in the early 1940s.

The house was later inherited by Helen Kirk who sold it to Juanita and Will Soghikan in 1972. Later owners included Michael and Luisa Fertitta who owned it from 1977 until 1988 when it was purchased by the present owner, Arthur Lewbel.

## BIBLIOGRAPHY and/or REFERENCES

1906 map  
Middlesex County Register of Deeds, Cambridge, Mass. – Plan Book 158, Plan 10  
Town Directories.  
U.S. Census, various years.