

FORM B – BUILDING

MASSACHUSETTS HISTORICAL COMMISSION
MASSACHUSETTS ARCHIVES BUILDING
220 MORRISSEY BOULEVARD
BOSTON, MASSACHUSETTS 02125

Assessor's Number USGS Quad Area(s) Form Number

50/39	Boston North		
-------	-----------------	--	--

Town: Lexington

Place: (*neighborhood or village*)

Photograph



Address: 5 Audubon Road

Historic Name: French House

Uses: Present: residential

Original: residential

Date of Construction: 1911

Source: deeds

Style/Form: Shingle Style

Architect/Builder: unknown (Wm. Roger Greeley?)

Exterior Material:

Foundation: concrete

Wall/Trim: wood shingle/wood

Roof: asphalt shingle

Outbuildings/Secondary Structures:

garage

Major Alterations (*with dates*):

Condition: fair

Moved: no | x | yes | | **Date** _____

Acreage: 0.16 acre

Setting: residential neighborhood

Topographic or Assessor's Map

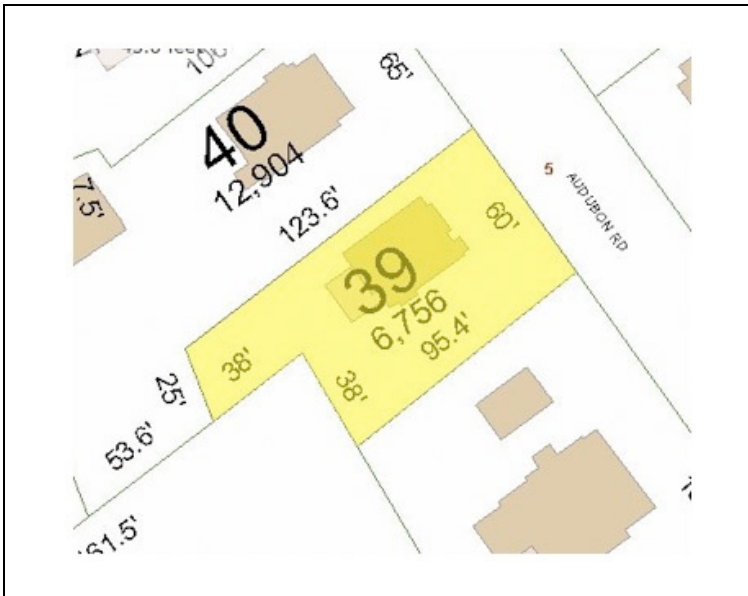

Recorded by: Lisa Mausolf

Organization: Lexington Historical Commission

Date (*month / year*): May 2008

INVENTORY FORM B CONTINUATION SHEET

LEXINGTON

5 AUDUBON ROAD

MASSACHUSETTS HISTORICAL COMMISSION

220 MORRISSEY BOULEVARD, BOSTON, MASSACHUSETTS 02125

Area(s) Form No.

--	--

Recommended for listing in the National Register of Historic Places.

If checked, you must attach a completed National Register Criteria Statement form.

ARCHITECTURAL DESCRIPTION:

Describe architectural features. Evaluate the characteristics of this building in terms of other buildings within the community.

Eclectic in its inspiration, the early 20th century house at 5 Audubon Road is a wood-shingled 1 ½-story structure with an asymmetrical gablefront. At the lower edge of the gable, the main entrance is marked by a shallow, shed hood supported by two simple trusses. It appears that this was originally an open, recessed porch but was later enclosed by continuous windows. Adjacent to the entrance is a single bay of window openings. The original windows have been replaced by a set of three casement units on both the first and second floors; the upper set is sheltered by a shed hood with a lunette fan in the attic. A long shed dormer projects from the south slope of the house and is punctuated by an individual, pair and set of three casement windows. A brick chimney rises off the ridge of the asphalt roof; the house is set on a concrete foundation.

A paved driveway extends to the south of the house terminating at a well-preserved, early 20th century garage. The wood-shingled structure is capped by a high hip roof which is sheathed in asphalt shingles. The double doors on the front have 4 x 2 glass panes over vertical panels.

HISTORICAL NARRATIVE

Discuss the history of the building. Explain its associations with local (or state) history. Include uses of the building, and the role(s) the owners/occupants played within the community.

This property comprises the south part of lot 9 and the north part of lot 8 on the Augustus Scott parcel of land which was lotted in 1903 (see 277 Waltham Street, MHC#461). Deed research indicates that the land on which the house stands was sold by Katherine B. Stone, wife of Edward C., to William Roger Greeley in 1911 (Book 3595, Page 303). The Stones lived at 9 Audubon Road. It seems likely that Greeley, an architect, designed and built the house although there is no evidence that he ever lived here (he is listed as living on Somerset Road during this period).

By 1920 the property was being rented to three sisters, Mary, Grace and Harriet French. Two years later Greeley deeded the property to Grace, Harriet and Helen French. Directories indicate that Grace worked as a teacher, Harriet was a stenographer, and Helen was a professor at Wellesley College. Mary's employment is not listed. The property remained in the French family until 1971 when it was sold by Helen French's estate to the present owners, Robert and Martha Martin.

BIBLIOGRAPHY and/or REFERENCES

Middlesex County Registry of Deeds, Cambridge, Mass. – Plan Book 158, Plan 10.

Town Directories

U.S. Census, various years.