

# FORM B – BUILDING

MASSACHUSETTS HISTORICAL COMMISSION  
MASSACHUSETTS ARCHIVES BUILDING  
220 MORRISSEY BOULEVARD  
BOSTON, MASSACHUSETTS 02125

Assessor's Number USGS Quad Area(s) Form Number

|       |  |  |      |
|-------|--|--|------|
| 65/49 |  |  | 2185 |
|-------|--|--|------|

**Town/City:** Lexington

**Place:** (*neighborhood or village*):

## Photograph



West and south elevations

## Locus Map

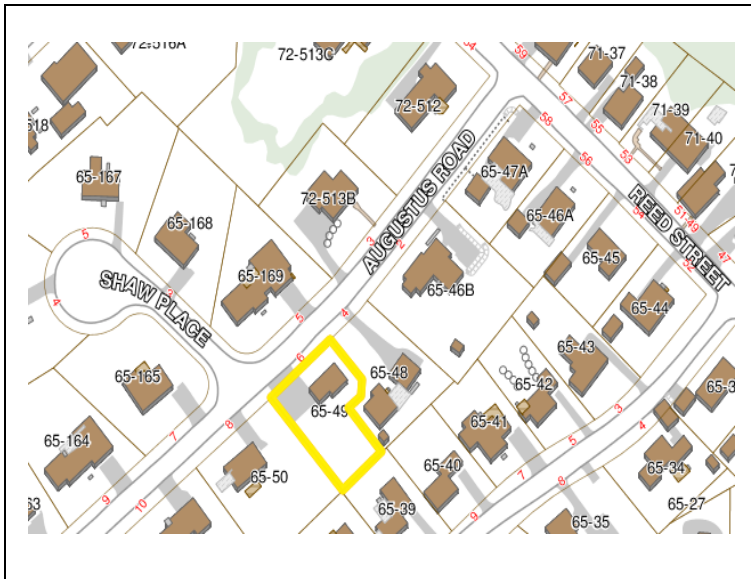

**Address:** 6 Augustus Road

**Historic Name:**

**Uses:** Present: residential

Original: agricultural extension service

**Date of Construction:** ca. 1900-35

**Source:** town directories, maps

**Style/Form:** no style

**Architect/Builder:**

**Exterior Material:**

Foundation: granite rubble

Wall/Trim: wood shingles and trim

Roof: asphalt shingles

**Outbuildings/Secondary Structures:**  
None

**Major Alterations** (*with dates*):

**Condition:** good

**Moved:** no  yes  **Date:**

**Acreage:** 0.26

**Setting:** Quiet residential side street lined with mostly mid-20<sup>th</sup> century houses.

**Recorded by:** Wendy Frontiero

**Organization:** Lexington Historical Commission

**Date** (*month / year*): September 2015

# INVENTORY FORM B CONTINUATION SHEET

LEXINGTON

6 AUGUSTUS ROAD

MASSACHUSETTS HISTORICAL COMMISSION

220 MORRISSEY BOULEVARD, BOSTON, MASSACHUSETTS 02125

Area(s) Form No.

|  |      |
|--|------|
|  | 2185 |
|--|------|

Recommended for listing in the National Register of Historic Places.

*If checked, you must attach a completed National Register Criteria Statement form.*

*Use as much space as necessary to complete the following entries, allowing text to flow onto additional continuation sheets.*

## ARCHITECTURAL DESCRIPTION:

*Describe architectural features. Evaluate the characteristics of this building in terms of other buildings within the community.*

6 Augustus Road faces the side of an L-shaped lot that slopes up to the left and the back. The building is one-story on its uphill, back elevation and two stories at its front façade, which faces the right side of the parcel. The large, roughly 38 by 44 foot structure is rectangular, with an inset, enclosed porch at the back right corner. A rocky outcropping occupies much of the street edge, while lawn areas are adjacent to the front and back elevations. Six closely spaced, mature evergreen trees form a diagonal line between the house and a paved parking area at the right side of the lot.

The building rises 2 ½ stories from a granite rubble foundation to a side gable roof. Walls are clad with wood shingles. Windows typically have 6/6 sash and flat casings without molding. The five bay façade has a center entrance with a single-leaf door and simple braced hood; windows are asymmetrically placed and of varied heights.

The left (street) elevation is asymmetrically composed, with no windows on the lower level, five windows across the upper floor (three 6/6 and two 4/4), and one narrow 2/2 window and paired 6/6 sash in the peak. The back elevation (facing the left side of the lot) has three windows and a gabled dormer with paired windows in the main block, near the street, and an enclosed sunroom at the far corner of the building.

6 Augustus Road is a vernacular, locally unique building; its form is reminiscent of barn construction. The house is notable for being built into a slope, its simple massing and informal fenestration, and the striking diagonal line of trees across the façade.

## HISTORICAL NARRATIVE

*Discuss the history of the building. Explain its associations with local (or state) history. Include uses of the building, and the role(s) the owners/occupants played within the community.*

6 Augustus Road represents Lexington's transition from an agricultural economy to a residential suburb in the early 20<sup>th</sup> century. Assessors' records for this house show a construction date of 1915, which has not been confirmed. Augustus Street appears in the town directories only between 1955 and 1965, when the land appears to have been subdivided for the present mid-20<sup>th</sup> century suburban homes that now dominate the street. In 1898, the land appears to have been part of a large estate belonging to F. O. Vaille, whose house was in this general vicinity.

Augustus Road extends between present-day 58 and 64 Reed Street, and this property appears to have been known as 62 Reed Street in the early 20<sup>th</sup> century. By 1922, the property at 62 Reed Street was occupied by Perley Tibbetts, a builder, and his wife Lillian. By 1935, property in this vicinity (listed as 64 Reed) was occupied by Henry J. Wollrath, a florist with Wollrath & Sons, Inc., which also had a Reed Street address. By 1945, Wollrath was living at what was identified as 60 Reed Street; Fred Trimhold, another florist, and his wife Frances were identified at 62 Reed Street. By 1955, different families are identified at these two addresses, including Charles R. Alexander, a salesman, and his wife Dorothy at #62. By 1965, Alexander, still a salesman, is listed as living at the present-day address of 6 Augustus Road. Deed research and additional research on Wollrath & Sons is merited to trace the history of this property more exactly.

Given the form and vernacular design of this building, and its proximity to the ca. 1930 Dutch Colonial house and garage next door at 4 Augustus Road, it is possible that 6 Augustus Road was constructed as a barn or other outbuilding related to 4 Augustus and/or the Wollrath florist business. Local historian Sam Doran notes that the building was the original site of the Agricultural Extension Service's Market Gardening Branch. Contact Senator Mike Barrett for further information.

# INVENTORY FORM B CONTINUATION SHEET

LEXINGTON

6 AUGUSTUS ROAD

MASSACHUSETTS HISTORICAL COMMISSION

220 MORRISSEY BOULEVARD, BOSTON, MASSACHUSETTS 02125

Area(s) Form No.

|  |      |
|--|------|
|  | 2185 |
|--|------|

---

## BIBLIOGRAPHY and/or REFERENCES

Historic maps and atlases: Walling 1853; Beers 1875; Walker 1889; Stadly 1898; Walker 1906; Sanborn 1908, 1918, 1927, 1935, 1935/1950.

Lexington Directories, 1899, 1908-09, 1922, 1934, 1936

Lexington *List of Persons*, 1935, 1945, 1955, 1965.

Massachusetts Historical Commission. "MHC Reconnaissance Survey Town Report: Lexington." 1980.

**INVENTORY FORM B CONTINUATION SHEET**

LEXINGTON

6 AUGUSTUS ROAD

MASSACHUSETTS HISTORICAL COMMISSION  
220 MORRISSEY BOULEVARD, BOSTON, MASSACHUSETTS 02125

Area(s) Form No.

|  |      |
|--|------|
|  | 2185 |
|--|------|

**SUPPLEMENTARY IMAGES**



South elevation



West elevation



Rear (north) elevation



Assessors' photograph: Rear and left side elevations