

FORM B – BUILDING

Assessor's Number USGS Quad Area(s) Form Number

71/218	Boston North		1588
--------	--------------	--	------

MASSACHUSETTS HISTORICAL COMMISSION
 MASSACHUSETTS ARCHIVES BUILDING
 220 MORRISSEY BOULEVARD
 BOSTON, MASSACHUSETTS 02125

Town: Lexington

Place: (*neighborhood or village*)

Photograph



Address: 6 Linmoor Terrace

Historic Name: Edward H. Nowers House

Uses: Present: residential

Original: residential

Date of Construction: 1909

Source: *Minute-man*, July 24, 1909

Style/Form: Colonial Revival/Craftsman

Architect/Builder: unknown

Exterior Material:

Foundation: fieldstone

Wall/Trim: wood clapboards

Roof: asphalt shingles

Outbuildings/Secondary Structures:

garage

Major Alterations (*with dates*):

date? – replacement windows

Condition: good

Moved: no | x | yes | | **Date** _____

Acreage: 0.49 acre

Setting: on knoll in mixed residential neighborhood

Topographic or Assessor's Map

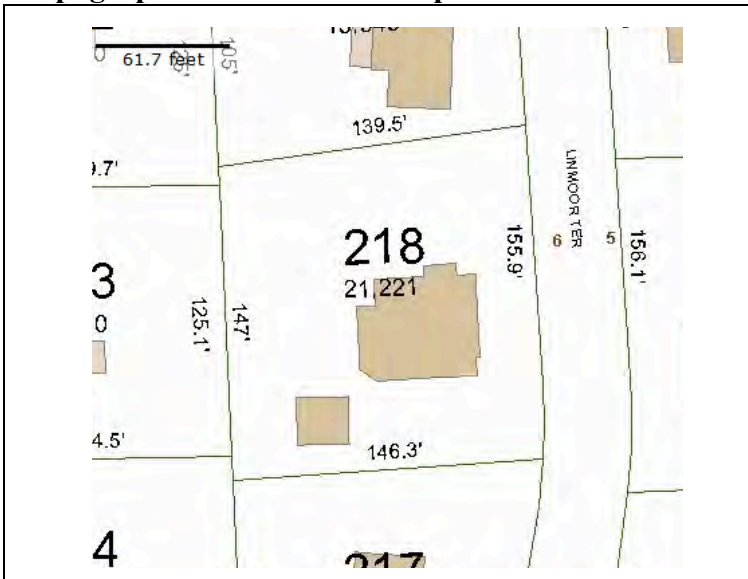

Recorded by: Lisa Mausolf

Organization: Lexington Historical Commission

Date (month / year): May 2008

INVENTORY FORM B CONTINUATION SHEET

LEXINGTON

6 Linmoor Terrace

MASSACHUSETTS HISTORICAL COMMISSION

Area(s) Form No.

220 MORRISSEY BOULEVARD, BOSTON, MASSACHUSETTS 02125

1588

___ Recommended for listing in the National Register of Historic Places.

If checked, you must attach a completed National Register Criteria Statement form.

ARCHITECTURAL DESCRIPTION:

Describe architectural features. Evaluate the characteristics of this building in terms of other buildings within the community.

Setback on a hill above North Hancock Street, what is now known as 6 Linmoor Terrace is a 2 ½-story, hip-roofed dwelling constructed in the early years of the 20th century and displaying elements of both the Craftsman and Colonial Revival styles. The house is rectangular in plan and oriented with its broad façade facing south and its end to Linmoor Terrace. It rests on a mortared fieldstone foundation and the same stone forms a base for the full-width, three-bay wide front porch that continues around part of the west elevation. The porch is supported by pairs of Doric columns which rest on stone posts with sets of three at the front corners of the porch. The house is outlined by simple cornerboards and the eaves of the hip roof are projecting and boxed. Hip dormers punctuate the roof in addition to a fieldstone chimney on the west slope. Windows contain a mix of individual and paired openings which contain replacement 1/1 sash. Centered on the second floor of the façade is a projecting tripartite window.

HISTORICAL NARRATIVE

Discuss the history of the building. Explain its associations with local (or state) history. Include uses of the building, and the role(s) the owners/occupants played within the community.

This house was constructed in the early 20th century and originally had a 74 North Hancock Street address. (Linmoor Terrace was created in the 1950s).

The first owner appears to have been Edward H. Nowers (b.1867) who came to Lexington in 1907. According to deeds, William R. Greeley sold this land to Effie Nowers, wife of Edward in August 1909 (Book 3458, Page 471). Edward was treasurer of a marine works and Effie was a Sunday School superintendent. On July 24, 1909 the *Minute-man* reported that “Edward H. Nowers is to build a house in North Lexington for a home for his family”. By 1920 the house was owned and occupied by Clarence and Abbie Fuller. He was employed as the manager of a cocoa company.

Later owners included Margaret Rice and the Kuehnle family who owned the property from 1965 until 1996.

BIBLIOGRAPHY and/or REFERENCES

1906 map

Hudson, Charles. *History of the Town of Lexington*. Cambridge: The Riverside Press Co., 1913.

Lexington Minute-man, July 24, 1909.

Middlesex South Registry of Deeds, Cambridge, MA

Town Directories

U.S. Census, various years.