

FORM B – BUILDING

Assessor's Number USGS Quad Area(s) Form Number

48/246	Boston North		
--------	-----------------	--	--

MASSACHUSETTS HISTORICAL COMMISSION
 MASSACHUSETTS ARCHIVES BUILDING
 220 MORRISSEY BOULEVARD
 BOSTON, MASSACHUSETTS 02125

Town: Lexington

Place: *(neighborhood or village)*

Photograph



Address: 6-8 Manley Court

Historic Name: Manley Double House

Uses: Present: residential

Original: residential

Date of Construction: c.1890

Source: maps

Style/Form:

Architect/Builder: unknown

Exterior Material:

Foundation: stone

Wall/Trim: asphalt shingles

Roof: asphalt shingles

Outbuildings/Secondary Structures:
none

Major Alterations *(with dates):*

Date? – asphalt siding, porch alt., new windows, rear addition and deck

Condition: good

Moved: no | x | yes | | **Date** _____

Acreage: 0.15 acre

Setting: mixed residential neighborhood off Woburn Street

Topographic or Assessor's Map

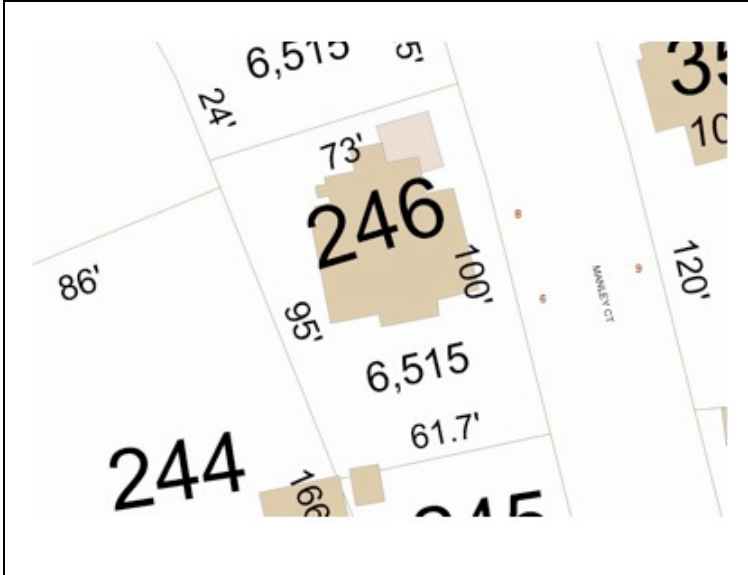

Recorded by: Lisa Mausolf

Organization: Lexington Historical Commission

Date *(month / year):* January 2010

INVENTORY FORM B CONTINUATION SHEET

LEXINGTON

6 Manley Court

MASSACHUSETTS HISTORICAL COMMISSION

220 MORRISSEY BOULEVARD, BOSTON, MASSACHUSETTS 02125

Area(s) Form No.

--	--

Recommended for listing in the National Register of Historic Places.
If checked, you must attach a completed National Register Criteria Statement form.

ARCHITECTURAL DESCRIPTION:

Describe architectural features. Evaluate the characteristics of this building in terms of other buildings within the community.

The building at 6-8 Manley Court is a 2 ½-story, 4 x 2-bay, double house oriented with its east gable end to Manley Court. The house rests on a mortared fieldstone foundation and is sheathed in asphalt shingles. The gable roof is sheathed in asphalt shingles and has projecting eaves that end in returns. Two corbel cap brick chimneys rise from the ridge. A simple, hip-roofed porch shelters the two main entrances which are centered on the south façade. The porch is supported by plain posts and the stick railings are modern. Windows contain modern vinyl 6/6 sash. There is a single-story addition and deck at the rear.

HISTORICAL NARRATIVE

Discuss the history of the building. Explain its associations with local (or state) history. Include uses of the building, and the role(s) the owners/occupants played within the community.

This was the first house constructed on Manley Court which was laid out about 1895. It does not appear on the 1889 map but was depicted on the 1898 map. It is one of several dwellings owned and/or constructed by the Manley Family in the Woburn Street area in the late 19th century (see also 48, 50, 75 Woburn Street). The Manley family was one of many in the Woburn Street neighborhood that immigrated to this country from Ireland in the 1850s and 1860s. One of the first to arrive in Lexington appears to have been Dennis Manley (d.1886). The 1880 Census lists his occupation as farm laborer. His son Michael Manley also lived on Woburn Street and was a day laborer. In 1906 the house was owned by C.J. Manley. Cornelius J. Manley was a butcher.

This double house appears to have been constructed as a rental property. In 1910 the house was occupied by the families of John Welch, a painter, and Silas Samuels, a coachman. In 1922 the occupants were Mrs. Mary Byrne and Mr. and Mrs. Frank Sullivan. Mrs. Byrne was still living here in 1932; the other unit was occupied by George Ingram.

The building remained in the Manley family until 1945 when it was sold by Charles A. Manley to Charles W. Savage.

BIBLIOGRAPHY and/or REFERENCES

Hudson, Charles. *History of the Town of Lexington*. Cambridge: The Riverside Press Co., 1913, vol. 2, p. 404.
Middlesex South Registry of Deeds, Cambridge, Mass.
Town Directories
U.S. Census, various years.
1889, 1898, 1906 maps