

# FORM B – BUILDING

15/47B                2254

MASSACHUSETTS HISTORICAL COMMISSION  
MASSACHUSETTS ARCHIVES BUILDING  
220 MORRISSEY BOULEVARD  
BOSTON, MASSACHUSETTS 02125

**Town/City:** Lexington

**Place:** (*neighborhood or village*):

## Photograph



Left side and front (façade) elevations

**Address:** 5 Meadow Brook Avenue

**Historic Name:**

**Uses:** Present: residential

Original: residential

**Date of Construction:** ca. 1890-1925

**Source:** architectural features, historic maps

**Style/Form:** No style

**Architect/Builder:**

**Exterior Material:**

Foundation: poured concrete

Wall/Trim: asbestos siding

Roof: asphalt siding

**Outbuildings/Secondary Structures:**

Detached garage

**Major Alterations** (*with dates*):

Asbestos siding (M 20<sup>th</sup> c), front (?) and rear extensions (E – M 20<sup>th</sup> c?)

**Condition:** fair

**Moved:** no  yes  **Date:**

**Acreage:** 0.31

**Setting:** Residential side street, adjacent to Dunback Meadow conservation land. Densely built, heterogeneous streetscape, with houses of varied age (turn of e 20<sup>th</sup> c – L 20<sup>th</sup> c), typically small in scale.

## Locus Map

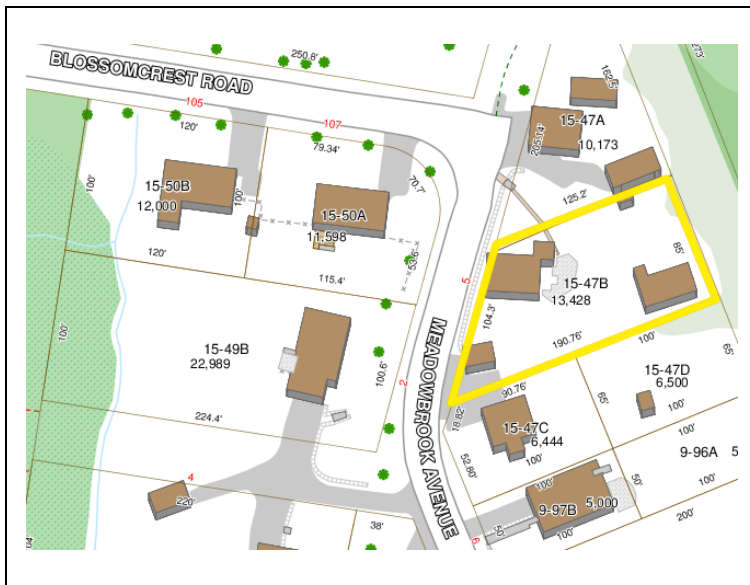

**Recorded by:** Wendy Frontiero

**Organization:** Lexington Historical Commission

**Date** (*month / year*): September 2015

Assessor's Number    USGS Quad    Area(s)    Form Number

# INVENTORY FORM B CONTINUATION SHEET

LEXINGTON

5 MEADOW BROOK Ave.

MASSACHUSETTS HISTORICAL COMMISSION

220 MORRISSEY BOULEVARD, BOSTON, MASSACHUSETTS 02125

Area(s) Form No.

2254

Recommended for listing in the National Register of Historic Places.

*If checked, you must attach a completed National Register Criteria Statement form.*

*Use as much space as necessary to complete the following entries, allowing text to flow onto additional continuation sheets.*

## ARCHITECTURAL DESCRIPTION:

*Describe architectural features. Evaluate the characteristics of this building in terms of other buildings within the community.*

5 Meadow Brook Avenue occupies a moderately sized lot that is raised above street level, contained by a fieldstone retaining wall along the street edge. The house is set in the front left corner of its lot, with a minimal front setback. Maintained chiefly in lawn, the property also contains scattered shrubs and small trees. Poured concrete steps at the left end of the retaining wall lead to a paved path to the back of the house. These steps are technically located on the adjacent parcel, under the same ownership as the house and with continuous landscaping. A free-standing garage stands at the right front corner of 5 Meadow Brook Ave., with pavement in front and along its right side. A concrete walkway leads from the paved area in front of the garage to the front entrance of the house. The building consists of a rectangular main block with a rear appendage.

The small main block rises 1 ½ stories from a poured concrete foundation to a front gable roof with no returns and one chimney on the left slope, at the center near the ridgeline. Walls are clad with asbestos siding. Windows typically have 2/1 double hung sash with band molding. The front façade has a one-story projection (possibly original) spanning its full length, comprised of a low hip roof, two symmetrical triplets of 2/1 windows at the front, and a single-leaf door with a metal awning and poured concrete steps on the right end. Above this enclosed sun porch, two closely spaced windows are centered in the half story.

The right side elevation has four windows, loosely grouped in pairs, and a small half-story dormer with a gable roof, no returns, one 2/1 window, and artificial siding. The left side elevation has two sets of paired 2/1 windows on the main block. A small, one-story addition with a shed roof projects from the back left corner of the main block, also rising from a poured concrete foundation. The addition has one center window facing the street and two symmetrical windows facing the left side of the property.

The small garage at the front right corner of the property has a front gable roof without returns, ship lap clapboards on the sides and gable peak, plywood flanking the door, and plain flat trim. On square window and an offset pedestrian door punctuate the right side elevation of the garage. The left side has one square window, asymmetrically placed.

Well preserved with the exception of its replacement siding, 5 Meadow Brook Avenue is a very modest, vernacular example of relatively early housing in outlying areas of Lexington. The house is notable for its remote location in a neighborhood of much later development, simple massing, front sun porch, and original or early garage.

## HISTORICAL NARRATIVE

*Discuss the history of the building. Explain its associations with local (or state) history. Include uses of the building, and the role(s) the owners/occupants played within the community.*

5 Meadow Brook Avenue represents Lexington's evolution from an agricultural community to a residential suburb. South Lexington was primarily an agricultural area until the mid 20<sup>th</sup> century, well connected to Lexington Center and nearby towns. Narrow, winding Allen Street formed the main road to Boston in the 17<sup>th</sup> and 18<sup>th</sup> centuries, until replaced by the straighter and more direct Waltham Street in the second quarter of the 19<sup>th</sup> century. Blossomcrest Road (then Blossom Street) joined Waltham and Allen streets by 1853, turning south at Allen Street to join Concord Avenue, which was established as the Concord Turnpike in 1806. By 1906, a street railway line ran down Waltham Street. The eastward extension of present-day Blossomcrest Road to Meadow Brook Avenue and Wellington Lane Avenue occurred in the early 20<sup>th</sup> century.

5 Meadow Brook Avenue is located at the southern end of Dunback Meadow, an extensive area of meadows, swamps, and farms that is today preserved as a 170-acre conservation property. Meadow Brook Avenue is first depicted and labeled on the

**INVENTORY FORM B CONTINUATION SHEET**

LEXINGTON

5 MEADOW BROOK Ave.

**MASSACHUSETTS HISTORICAL COMMISSION**

220 MORRISSEY BOULEVARD, BOSTON, MASSACHUSETTS 02125

Area(s) Form No.

2254

historic maps in 1926. Interestingly, an unnamed, isolated building is marked in the general vicinity of this house in 1898 only, possibly associated with the nearby farm of P. F. Hutchinson.

The first known occupants at this specific address, in 1935, were Charles Prilgousky, a meatpacker, his wife Emily (both born in Lithuania), and four children: Kostanti, a cleaner; Helen K., a rubber worker; Emily, a factory worker; and Allen, no occupation given. Charles and Emily Prilgousky, both born in Lithuania, may have lived here by 1930; from 1940 through 1955, Charles's occupation was described as a farmer. The Prilgousky family remained at the house through at least 1955. Helen P. Odell, a waitress, lived here with Charles and Emily Prilgousky in 1945. By 1955, Charles Prilgousky was accompanied here by Frank J. Sanderson, a pressman, his wife Charlotte, and their two children. By 1965, Frank and Charlotte Sanderson were the only adult occupants of the house.

Further research is recommended to document the early history and agricultural associations of this property.

**BIBLIOGRAPHY and/or REFERENCES**

Historic maps and atlases: Walling 1853; Beers 1875; Walker 1889; Stadly 1898; Walker 1906; Sanborn 1908, 1918, 1927, 1935, 1935/1950.

Lexington Comprehensive Cultural Resources Survey, Period and Area Summaries.

<http://historicsurvey.lexingtonma.gov/index.htm> Accessed Jul 23, 2015.

Lexington Directories: 1899, 1908-09, 1922, 1928, 1930, 1934, 1936.

Lexington Historical Commission. Form A – Area. Allen Street, LEX.W. Prepared by Nancy Seasholes, 1984.

Lexington *List of Persons*: 1935, 1945, 1955, 1965.

Massachusetts Historical Commission. "MHC Reconnaissance Survey Town Report: Lexington." 1980.

Town of Lexington, Clarence B. French, Town Engineer. "Map of the Town of Lexington, Massachusetts." 1926.

\_\_\_\_\_, William M. Burus, Town Engineer. "Precinct Map of the Town of Lexington, Massachusetts." 1948

Town of Lexington website. "Conservation Land." [www.lexingtonma.gov/conservation/conland.cfm#ConAreas](http://www.lexingtonma.gov/conservation/conland.cfm#ConAreas). Accessed Aug 23, 2015.

**INVENTORY FORM B CONTINUATION SHEET**

LEXINGTON

5 MEADOW BROOK Ave.

MASSACHUSETTS HISTORICAL COMMISSION  
220 MORRISSEY BOULEVARD, BOSTON, MASSACHUSETTS 02125

Area(s) Form No.

	2254
--	------

**SUPPLEMENTARY IMAGES**



Front (façade) elevation



Assessor's photograph: Front (façade) elevation



Front (façade) elevation of house and garage  
(front façade and right side elevations)