

FORM B – BUILDING

Assessor's Number USGS Quad Area(s) Form Number

48/224	Boston North		1619
--------	--------------	--	------

MASSACHUSETTS HISTORICAL COMMISSION
MASSACHUSETTS ARCHIVES BUILDING
220 MORRISSEY BOULEVARD
BOSTON, MASSACHUSETTS 02125

Town: Lexington

Place: (*neighborhood or village*)

Photograph



Address: 56 Vine Street

Historic Name:

Uses: Present: residential

Original: residential

Date of Construction: c.1906

Source: maps

Style/Form: Queen Anne

Architect/Builder: unknown

Exterior Material:

Foundation: stone

Wall/Trim: vinyl siding/wood

Roof: asphalt shingle

Outbuildings/Secondary Structures:

none

Major Alterations (*with dates*):

c.2000 – vinyl siding and new windows

Condition: fair (due to siding)

Moved: no | x | yes | | **Date** _____

Acreage: 0.72 acre

Setting: newer structure set above historic road lined by older residential structures

Topographic or Assessor's Map

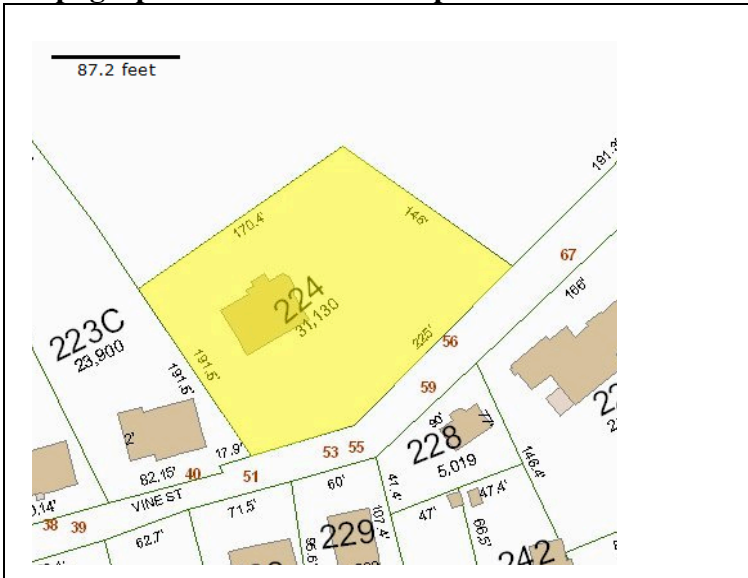

Recorded by: Lisa Mausolf

Organization: Lexington Historical Commission

Date (*month / year*): Jan. 2010

INVENTORY FORM B CONTINUATION SHEET

220 MORRISSEY BOULEVARD, BOSTON, MASSACHUSETTS 02125

LEXINGTON

56 Vine Street

	1619
--	------

Recommended for listing in the National Register of Historic Places.

If checked, you must attach a completed National Register Criteria Statement form.

ARCHITECTURAL DESCRIPTION:

Describe architectural features. Evaluate the characteristics of this building in terms of other buildings within the community.

Set on a hill above the street, 56 Vine Street is a vernacular Queen Anne-style dwelling which appears to date to the early 20th century. Resting on a stone foundation, the 2 ½-story structure consists of a side-gabled main block with a cross gable projecting from the east end. The façade of the main block is fronted by a single-story porch supported by turned posts with decorative brackets and a turned balustrade. Under the porch the entrance consists of a simple doorway. The projecting gable has cut-away corners and cornice returns. The windows contain modern 2/1 sash and are used individually, in pairs and in sets of three. There is a small square fixed window with “Queen Anne”-style colored glass centered on the second floor of the façade below a hip-roofed dormer. Other details include several single-story, three-sided bay windows.

HISTORICAL NARRATIVE

Discuss the history of the building. Explain its associations with local (or state) history. Include uses of the building, and the role(s) the owners/occupants played within the community.

There does not appear to be a house on this site at the time of the 1906 map. The first owner may have been Mary O’Brien who apparently owned the property in 1915 (Plan Book 240, Plan 22). By 1926 Florence Morrison was the owner (Book 5007, Page 81). The property was later owned by Joseph Swan, a real estate agent. Members of the Swan family sold the property to Murray Potter in 1982.

BIBLIOGRAPHY and/or REFERENCES

Middlesex County Register of Deeds, Cambridge, Mass.
Town Directories
U.S. Census, various years.