

# FORM B – BUILDING

Assessor's Number USGS Quad Area(s) Form Number

50/37	Boston North		1546
-------	--------------	--	------

MASSACHUSETTS HISTORICAL COMMISSION  
 MASSACHUSETTS ARCHIVES BUILDING  
 220 MORRISSEY BOULEVARD  
 BOSTON, MASSACHUSETTS 02125

**Town:** Lexington

**Place:** (*neighborhood or village*)

## Photograph



**Address:** 15 Audubon Road

**Historic Name:**

**Uses:** Present: residential

Original: residential

**Date of Construction:** c.1920

**Source:** directories, Census records

**Style/Form:** Dutch Colonial (Colonial Revival)

**Architect/Builder:** unknown

**Exterior Material:**

Foundation: stone

Wall/Trim: wood shingle/wood

Roof: asphalt shingle

**Outbuildings/Secondary Structures:**  
garage

**Major Alterations (*with dates*):**  
2007 – addition to south

**Condition:** good

**Moved:** no | x | yes | | **Date** \_\_\_\_\_

**Acreage:** 0.21 acre

**Setting:** residential neighborhood

## Topographic or Assessor's Map

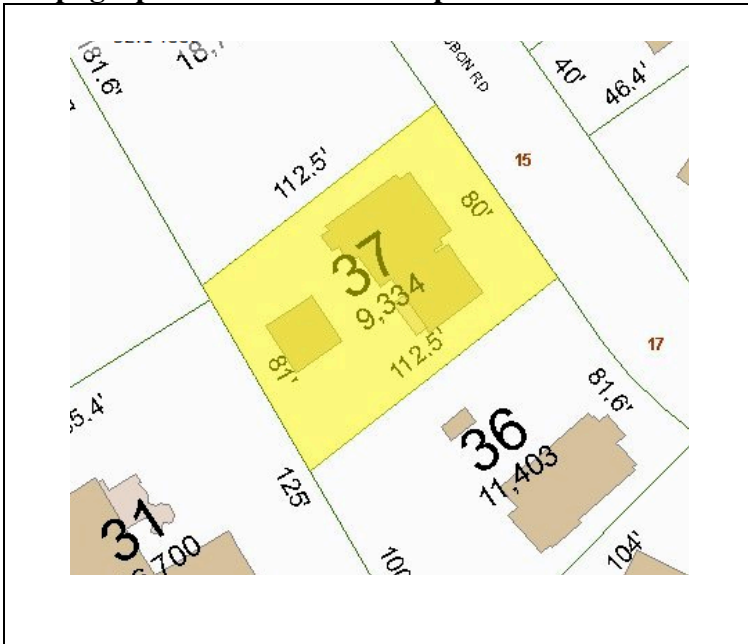

**Recorded by:** Lisa Mausolf

**Organization:** Lexington Historical Commission

**Date (*month / year*):** May 2008

**INVENTORY FORM B CONTINUATION SHEET**

LEXINGTON

15 AUDUBON ROAD

MASSACHUSETTS HISTORICAL COMMISSION

220 MORRISSEY BOULEVARD, BOSTON, MASSACHUSETTS 02125

Area(s) Form No.

1546

Recommended for listing in the National Register of Historic Places.

*If checked, you must attach a completed National Register Criteria Statement form.*

**ARCHITECTURAL DESCRIPTION:**

*Describe architectural features. Evaluate the characteristics of this building in terms of other buildings within the community.*

Doubled in size by a recent but sympathetic addition at its south end, 15 Audubon Road is a good example of the Dutch Colonial style. Characteristic of the style, the two-story house displays a side gambrel form with a full-width shed dormer. It rests on a mortared stone foundation and is sheathed in wood shingles with an asphalt-shingled roof and a brick chimney rising from the rear slope. The offcenter entrance is marked by a single-bay glazed vestibule which is sheltered by a shed extension of the front roof slope. Adjacent to the entrance is a set of four 6/1 windows with blinds. Upstairs, punctuating the shed dormer are two pairs of 6/1 windows. The north end of the building features a mix of 6/1 windows and a single-story rear addition is a single bay deep.

The front wall of the 2007 addition to the south is set back slightly from the façade of the original building. Its massing, sheathing, roof and windows are all imitative of the original although it is set on a poured concrete foundation. Originally a much smaller, single-story, flat-roofed sunporch spanned the south side of the house.

Behind the house is a garage oriented with its gambrel front facing north. It is sheathed in wood shingles with folding doors, a glass and panel door and 6/1 windows.

**HISTORICAL NARRATIVE**

*Discuss the history of the building. Explain its associations with local (or state) history. Include uses of the building, and the role(s) the owners/occupants played within the community.*

This property stands on part of the land subdivided by Augustus Scott (see 277 Waltham Street, MHC #461) in 1903 but apparently remained unbuilt upon for some time. There does not appear to be a Census entry for 15 Audubon in either the 1920 or 1930 Census. This house appears to date to the early 1930s – its earliest known owners were Harold and Ruth Geddes who were living here by 1942. Mrs. Geddes continued to own the property until 1986 when she sold it to Doris Stone. It has had a number of owners since that time including Roderick and Judith Crocker, Christopher Zikakis and Paul and Patricia Hochman, who added the large addition in 2007.

**BIBLIOGRAPHY and/or REFERENCES**

Middlesex County Register of Deeds, Cambridge, Mass. – Plan Book 158, Plan 10  
Town Directories  
U.S. Census, various years.