

FORM B – BUILDING

MASSACHUSETTS HISTORICAL COMMISSION
MASSACHUSETTS ARCHIVES BUILDING
220 MORRISSEY BOULEVARD
BOSTON, MASSACHUSETTS 02125

Assessor's Number USGS Quad Area(s) Form Number

007100089A Boston N. 773

Town Lexington

Place (neighborhood or village)

Address 265 Bedford St./9 North Hancock St.

Historic Name Nathan H. Reed House

Uses: Present Multi-Family Residential

Original Residential

Date of Construction 1844

Source Lexington Valuation lists

Style/Form Greek Revival

Architect/Builder

Exterior Material:

Foundation Granite/Fieldstone/Brick

Wall/Trim Wood Clapboard

Roof Asphalt Shingle

Outbuildings/Secondary Structures

Major Alterations (with dates)

Rear additions (dates unknown)

Condition Good

Moved no yes Date

Acreage 0.2 A.

Setting At the corner of a street with constant traffic and a major side street; across from a gas station and in a neighborhood of 19th- and 20th-century houses

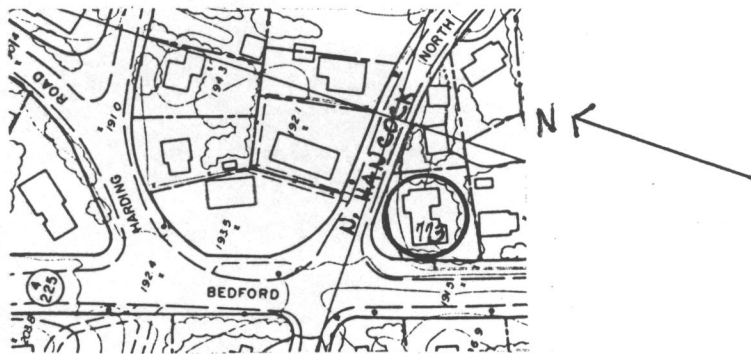

Recorded by Nancy S. Seasholes

Organization Lexington Historical Commission

Date (month / year) April 1998