

FORM E - BUILDING

MASSACHUSETTS HISTORICAL COMMISSION
Office of the Secretary, State House, Boston

In Area no.	Form no.
B	82



m Lexington

ress 14-16 Bedford Street

ie _____

sent use double house

ent owner _____

ription: 1890 (betw. 1889+1903)

urce Owner
Queen Anne?

map. Draw sketch of building location in relation to nearest cross streets and other buildings. Indicate north.

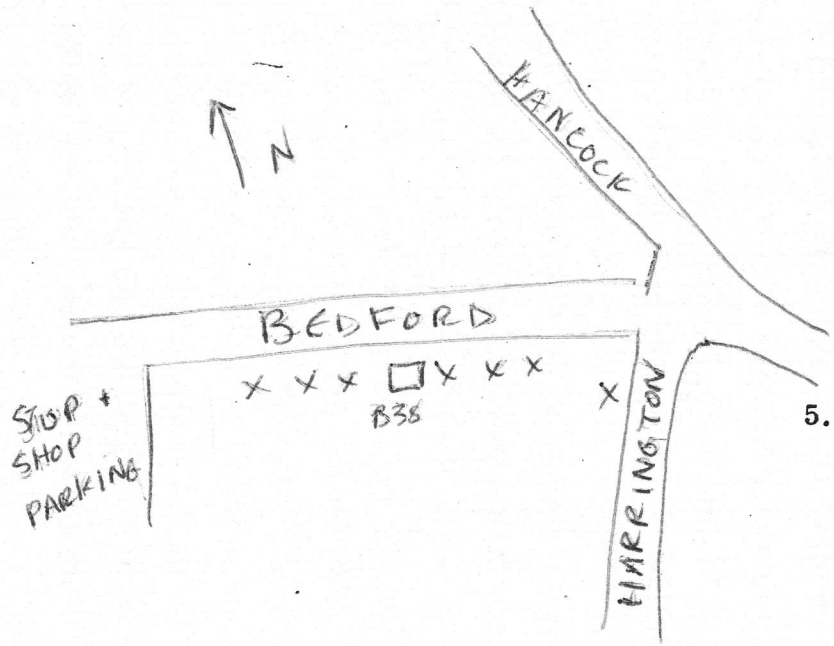

Architect _____

Exterior wall fabric clapboard

Outbuildings (describe) non visible

Other features field stone foundation

cross gable front element over Q. Anne porch
turned posts. (over)

Altered _____ Date _____

Moved _____ Date _____

5. Lot size:
One acre or less x Over one acre _____

Approximate frontage 50'

Approximate distance of building from street
15'

6. Recorded by E. W. Reinhardt

Organization Lex.Hist. Com.

Date August 28, 1975

DO NOT WRITE IN THIS SPACE
USGS Quadrant _____
MHC Photo no. _____

(over)