

FORM B – BUILDING

MASSACHUSETTS HISTORICAL COMMISSION
MASSACHUSETTS ARCHIVES BUILDING
220 MORRISSEY BOULEVARD
BOSTON, MASSACHUSETTS 02125

Assessor's Number USGS Quad Area(s) Form Number

0078000113 Boston N. 778

Town Lexington

Place (neighborhood or village)

Address 330 Bedford St.

Historic Name Christopher Reed House #1

Uses: Present Residential

Original Residential

Date of Construction 1818

Source Lexington Valuation lists

Style/Form Federal

Architect/Builder

Exterior Material:

Foundation Granite

Wall/Trim Wood Clapboard/Wood Flushboard

Roof Asphalt Shingle

Outbuildings/Secondary Structures

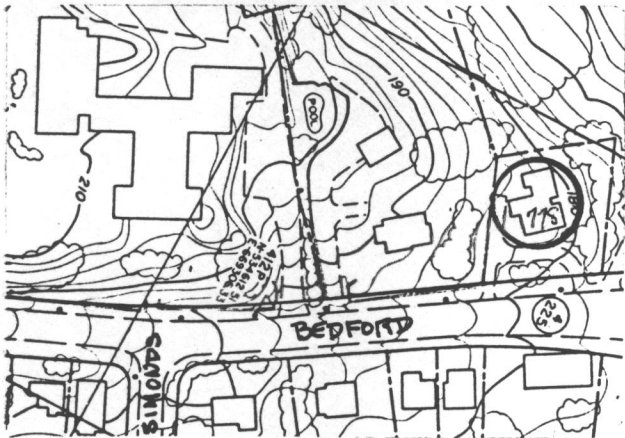

Major Alterations (with dates)
Roofline changed (date unknown)
Rear additions (dates unknown)

Condition Good/Fair

Moved no yes Date

Acreage 0.4 A.

Setting On a street with constant traffic; across from a Federal tavern

Recorded by Nancy S. Seasholes

Organization Lexington Historical Commission

Date (month / year) April 1998