

FORM B – BUILDING

Assessor's Number USGS Quad Area(s) Form Number

0064000161 Boston N. 752, 753

Town Lexington

Place (neighborhood or village)

Address 89-91 Bedford St.

Historic Name John Davis/Hosea Holt House

Uses: Present Multi-Family Residential

Original Residential

Date of Construction 1851

Source Lexington Valuation lists

Style/Form Italianate

Architect/Builder

Exterior Material:

Foundation Brick

Wall/Trim Wood Clapboard

Roof Asphalt Shingle

Outbuildings/Secondary Structures

Attached carriage house/garage

Major Alterations (with dates)

Second entry created (date unknown)

Condition Excellent

Moved no yes Date

Acreeage 1.6 A.

Setting Set back from a street with constant traffic in an area of early 20th-century houses

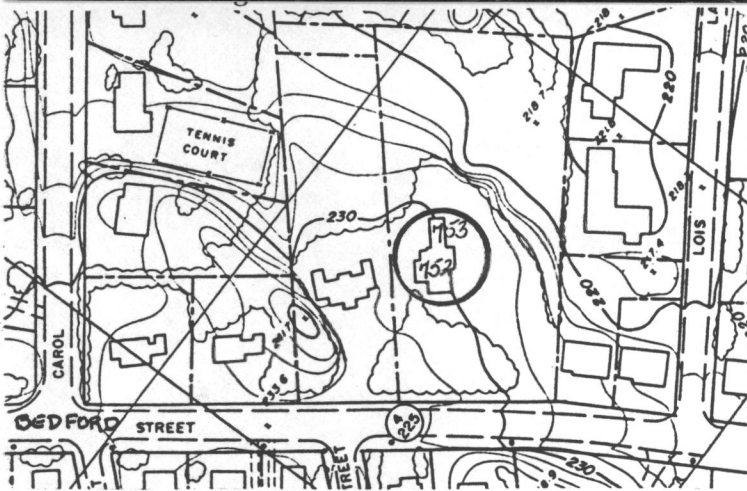

Recorded by Nancy S. Seasholes

Organization Lexington Historical Commission

Date (month / year) April 1998