

FORM B - BUILDING

AREA N	FORM NO. 484
-----------	-----------------

MASSACHUSETTS HISTORICAL COMMISSION
294 WASHINGTON STREET, BOSTON, MA 02108



Location Lexington

Address 50 Bloomfield Street

Historic Name I.H. Ames House
Willard O. Ames House

Use: Present residential

Original residential

DESCRIPTION:

Date c. 1895-1900 1896

Source Minute Man 7/31/1896
stylistic analysis

Style Shingle Style

Architect _____

Exterior wall fabric shingles

Outbuildings garage

Major alterations (with dates) _____

Moved _____ Date _____

Approx. acreage 17000 ft.²

Setting Suburban residential street; a mix of houses from the third quarter of the nineteenth century and the twentieth century.

SKETCH MAP

Show property's location in relation to nearest cross streets and/or geographical features. Indicate all buildings between inventoried property and nearest intersection. Indicate north.

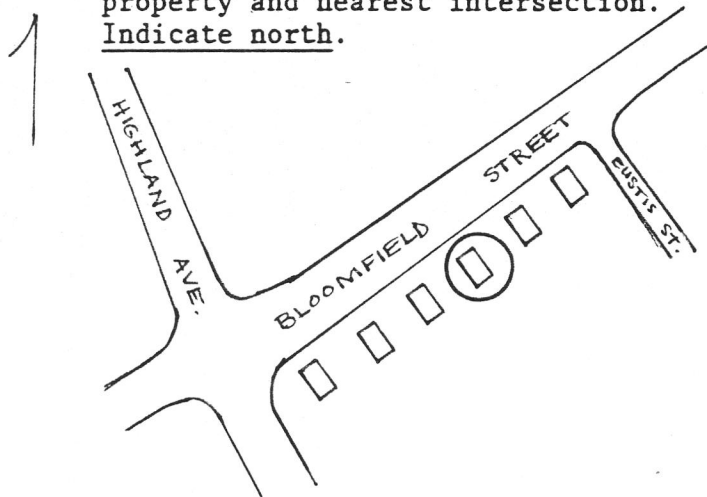

Recorded by Anne Grady

Organization Lexington Historical Commission

Date March, 1984

(Staple additional sheets here)