

FORM B - BUILDING

Assessor's number  
21/37

USGS Quad  
Boston N.

Area(s)

Form Number  
1042

Massachusetts Historical Commission



Town Lexington

Place (neighborhood or village) East Lexington

Address 35 Brandon Street

Historic Name Emile & Dorothy Vadeboncoeur House

Uses: Present Residential

Original Residential

Date of Construction 1927

Source Lexington Valuation Lists, Sanborn maps

Style/Form Bungalow

Architect/Builder unknown

Exterior Material:

Foundation not visible

Wall/Trim brick/vinyl

Roof asphalt shingle

Outbuildings/Secondary Structures

none

Major Alterations (with dates) date? - side addition;

1982 - damaged by fire, repaired and vinyl siding installed

Condition good

Moved  no  yes Date

Acreage 5,000 SF

Setting 20th century residential neighborhood

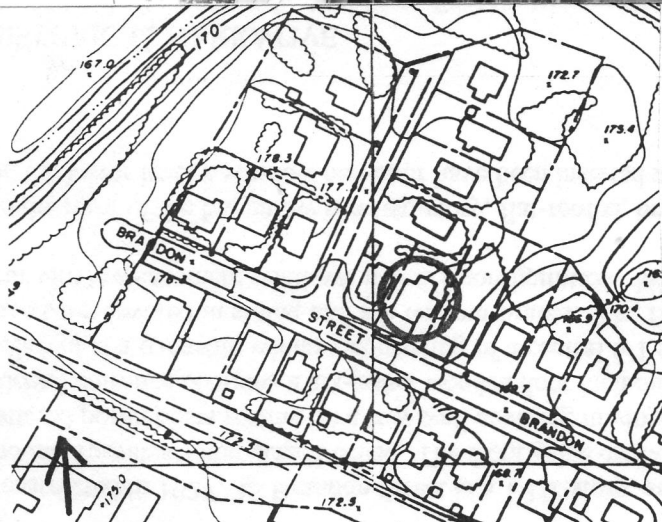

Recorded by Lisa Mausolf

Organization Lexington Historical Commission

Date (month/year) June 2000