

FORM B – BUILDING

MASSACHUSETTS HISTORICAL COMMISSION
MASSACHUSETTS ARCHIVES BUILDING
220 MORRISSEY BOULEVARD
BOSTON, MASSACHUSETTS 02125

Assessor's Number	USGS Quad	Area(s)	Form Number
006261-151	Boston N.		716

Town Lexington

Place (neighborhood or village)

Address 151 East St.

Historic Name Joseph Spaulding/Doran House

Uses: Present Multi-Family Residential

Original Residential

Date of Construction 1884

Source Lexington Valuation lists

Style/Form No Style

Architect/Builder

Exterior Material:

Foundation Fieldstone

Wall/Trim Wood Clapboard

Roof Asphalt Shingle

Outbuildings/Secondary Structures

Major Alterations (with dates)

Front porch removed, entry moved to side, addition to rear ell (1980s)

Condition Good

Moved no yes Date

Acreage Part of a condominium development

Setting Set fairly close to a busy street in a 1980s condominium development

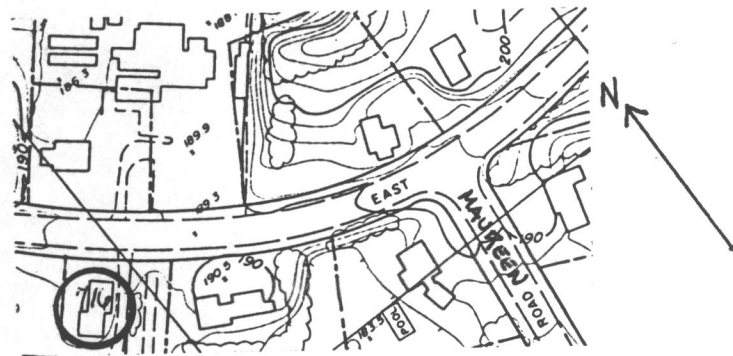

Recorded by Nancy S. Seasholes

Organization Lexington Historical Commission

Date (month / year) March 1998