

FORM B – BUILDING

MASSACHUSETTS HISTORICAL COMMISSION
MASSACHUSETTS ARCHIVES BUILDING
220 MORRISSEY BOULEVARD
BOSTON, MASSACHUSETTS 02125

Assessor's Number USGS Quad Area(s) Form Number

0054000928 Boston N. 664

Town Lexington

Place (neighborhood or village)

Address 455 Lowell St.

Historic Name Benjamin Wyman/S.H. Jones/Porter Farm

Uses: Present Residential

Original Residential

Date of Construction 1821

Source Lexington Valuation lists

Style/Form Federal (altered)

Architect/Builder

Exterior Material:

Foundation Granite (front), Concrete Block (back)

Wall/Trim Vinyl Siding

Roof Asphalt Shingle

Outbuildings/Secondary Structures Attached garage

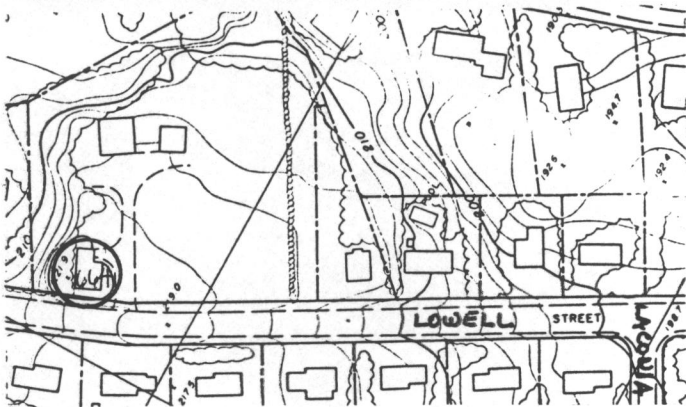

Major Alterations (with dates)

Roofline altered and rear extended (1980s?)

Condition Fair

Moved no yes Date

Acreeage 2.6 A.

Setting At edge of a large open field very close to a major street with constant traffic lined with 20th-century houses

Recorded by Nancy S. Seasholes

Organization Lexington Historical Commission

Date (month / year) February 1998