

FORM B - BUILDING

Assessor's number
32/158

USGS Quad
Boston N.

Area(s)

Form Number
1087

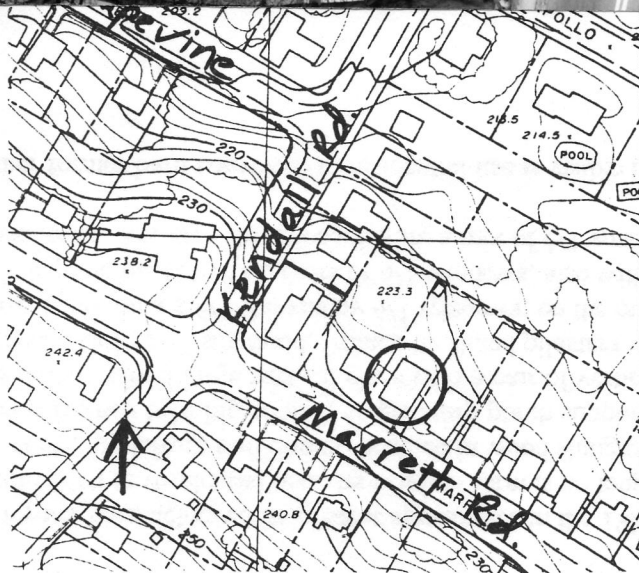

Town Lexington

Place (neighborhood or village)

Address 259 Marrett Road

Historic Name Bridge-Kendall Barn

Uses: Present Residential

Original Barn

Date of Construction 19th c.?

Source Worthen

Style/Form Astylistic

Architect/Builder unknown

Exterior Material:

Foundation concrete blocks

Wall/Trim wood shingle

Roof asphalt shingle

Outbuildings/Secondary Structures

none

Major Alterations (with dates) c.1920? - moved to present site and converted to residential use

Condition good

Moved no yes Date c.1920?

Acreage 8,211 SF

Setting early 20th century residential development on heavily traveled road

Recorded by Lisa Mausolf

Organization Lexington Historical Commission

Date (month/year) July 2000