

FORM B – BUILDING

MASSACHUSETTS HISTORICAL COMMISSION
MASSACHUSETTS ARCHIVES BUILDING
220 MORRISSEY BOULEVARD
BOSTON, MASSACHUSETTS 02125

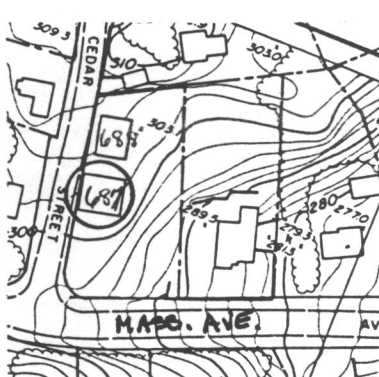
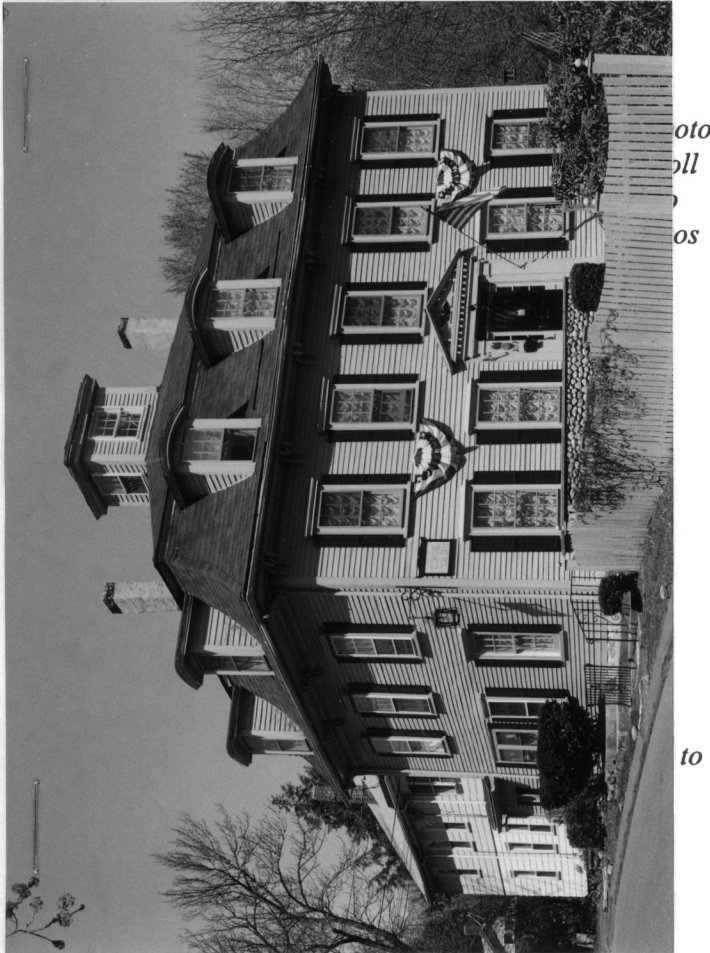

Assessor's Number USGS Quad Area(s) Form Number

0050000198 Boston N. 687

Town Lexington

Place (neighborhood or village)

Address 2173 Massachusetts Ave.

Historic Name John Parkhurst House

Uses: Present Residential

Original Residential

Date of Construction ca. 1780

Source Lexington Valuation lists; interior finishes

Style/Form Georgian/Second Empire

Architect/Builder John Parkhurst

Exterior Material:

Foundation Fieldstone

Wall/Trim Wood Clapboard

Roof Asphalt Shingle

Outbuildings/Secondary Structures

Major Alterations (with dates)

Mansard roof (1869–1871)

Ell detached and moved back (1898–1935 [range])

Rear addition (before 1935)

East first-story facade wall replaced, doorway pediment added, pilaster replaced (1967–1968)

Deck (1985)

West first-story wall repaired (1996)

Condition Good

Moved no yes Date

Acreage 0.3 A.

Setting Set back from a heavily trafficked street in an area of early 20th-century houses

Recorded by Nancy S. Seasholes

Organization Lexington Historical Commission

Date (month / year) March 1998