

FORM B - BUILDING

Assessor's number
50/54

USGS Quad
Boston N.

Area(s)

Form Number
1094



Town Lexington

Place (neighborhood or village)

Address 2210 Massachusetts Avenue

Historic Name George & Emilie Fuller House

Uses: Present Residential

Original Residential

Date of Construction 1931

Source Lexington Valuation Lists

Style/Form Tudor Revival

Architect/Builder unknown

Exterior Material:

Foundation stucco

Wall/Trim stucco, live edge wood siding

Roof slate

Outbuildings/Secondary Structures

none

Major Alterations (with dates)

Condition good

Moved no yes Date

Acreage 22,370 SF

Setting mixed residential on busy main road

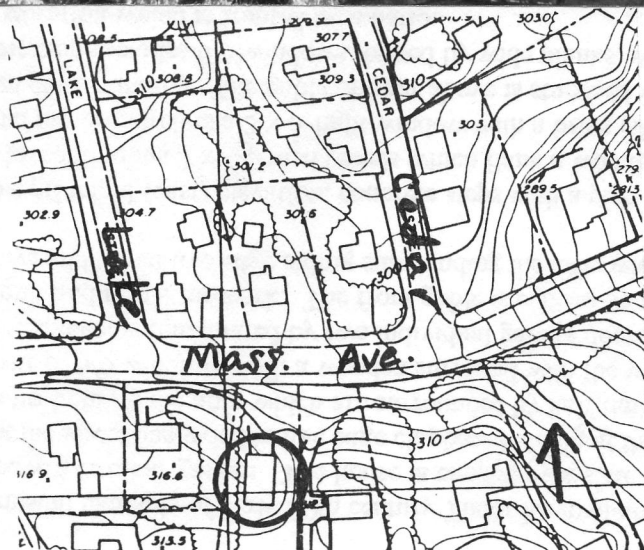

Recorded by Lisa Mausolf

Organization Lexington Historical Commission

Date (month/year) April 2000