

FORM B - BUILDING

Assessor's number
71/153A

USGS Quad
Boston N.

Area(s)

Form Number
1099



Town Lexington

Place (neighborhood or village)

Address 36 North Hancock Street

Historic Name Charles & Aleph Bertwell House

Uses: Present Residential

Original Residential

Date of Construction c.1898

Source Lexington Valuation Lists

Style/Form Queen Anne

Architect/Builder unknown

Exterior Material:

Foundation fieldstone

Wall/Trim wood clapboard/wood shingle

Roof asphalt shingle

Outbuildings/Secondary Structures

garage (1968)

Major Alterations (with dates) c.1998 - new entrance

porch

Condition good

Moved no yes Date

Acreage 20,500 SF

Setting early 20th century residential neighborhood

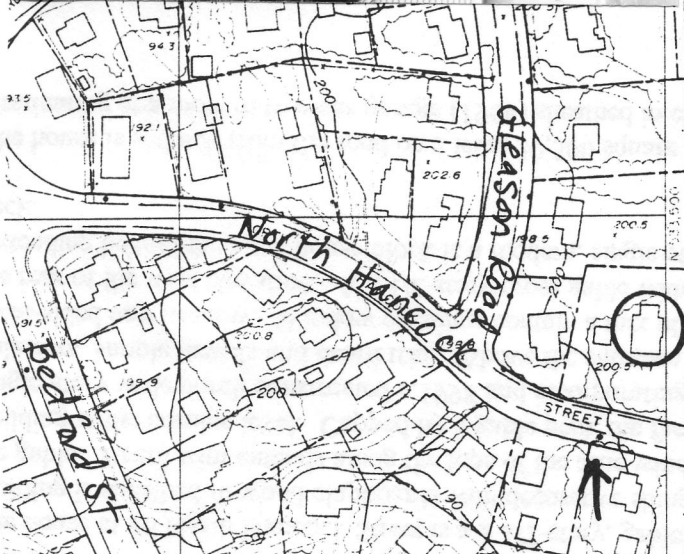

Recorded by Lisa Mausolf

Organization Lexington Historical Commission

Date (month/year) June 2000