

# FORM B – BUILDING

MASSACHUSETTS HISTORICAL COMMISSION  
MASSACHUSETTS ARCHIVES BUILDING  
220 MORRISSEY BOULEVARD  
BOSTON, MASSACHUSETTS 02125

Assessor's Number    USGS Quad    Area(s)    Form Number  
           

**Town/City:**    Lexington  
**Place:** (*neighborhood or village*):  
                    Merriam Hill

**Address:**            10 Oakland Street

**Historic Name:**

**Uses:** Present:    residential  
                    Original:    residential

**Date of Construction:**    ca. 1910-18

**Source:**            assessors' records, town directories,  
                            U.S. census

**Style/Form:**        Bungalow

**Architect/Builder:**

**Exterior Material:**

Foundation:    fieldstone  
Wall/Trim:      stucco veneer with wood trim  
Roof:             asphalt shingles

**Outbuildings/Secondary Structures:**  
None

**Major Alterations (*with dates*):**  
---

**Condition:**        good  
**Moved:** no     yes     **Date:**  
**Acreage:**            0.20

**Setting:**    Set on the slope of a residential side street characterized by large, late 19<sup>th</sup> century homes. Houses are widely spaced but with comparatively modest front set backs. Sidewalk with planting strip on one side of street; mature street trees.

## Photograph



Front (facade) and right side elevations

## Locus Map

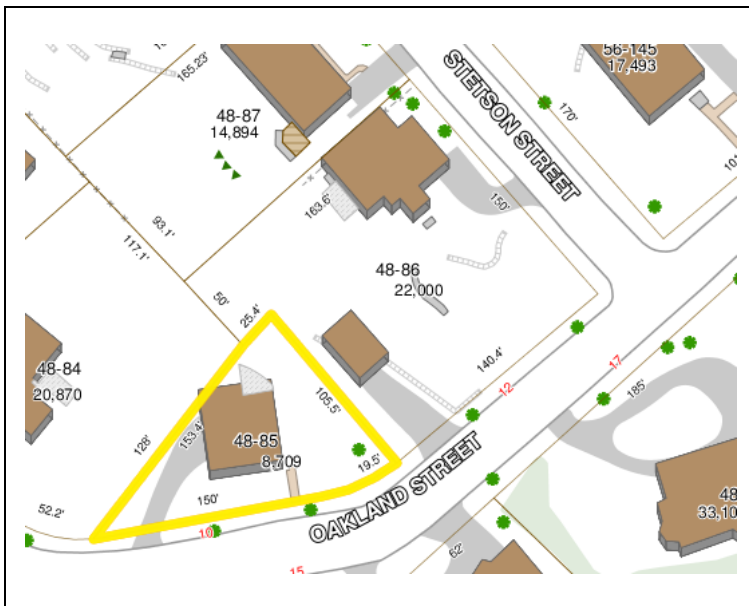

**Recorded by:**    Wendy Frontiero  
**Organization:**    Lexington Historical Commission  
**Date (*month / year*):**    September 2015

# INVENTORY FORM B CONTINUATION SHEET

LEXINGTON

10 OAKLAND STREET

MASSACHUSETTS HISTORICAL COMMISSION

220 MORRISSEY BOULEVARD, BOSTON, MASSACHUSETTS 02125

Area(s) Form No.

H

1169

Recommended for listing in the National Register of Historic Places.

*If checked, you must attach a completed National Register Criteria Statement form.*

*Use as much space as necessary to complete the following entries, allowing text to flow onto additional continuation sheets.*

## ARCHITECTURAL DESCRIPTION:

*Describe architectural features. Evaluate the characteristics of this building in terms of other buildings within the community.*

10 Oakland Street occupies a small triangular lot that rises steeply from left to right through the site, creating a fully-exposed basement on the left side of the building. The yard is maintained mostly in lawn at the front and right side, with mature trees scattered throughout, foundation plantings adjacent to the building, and a wooded back yard. A concrete walkway leads from the street to the right side of the building. A straight, paved driveway crosses the left side yard at a diagonal.

The approximately square building rises 1½ stories above a fully-exposed basement on the left side to a hip roof with deep eaves and a hip-roofed dormer centered on each slope. One chimney rises above the right slope. Walls are stucco with wood sill boards. Trimmed with wood band molding, windows have 6/1 (on the left side) and 9/1 (on the right side) double hung sash, with diamond-paned sash common in grouped windows. The three-bay façade has an 8/1 window on each side of a shallow center entrance vestibule, which features angled corners and a period door with wood and glass panels. Recessed below the front slope of the roof, a full-length porch has a solid concrete foundation and semi-open half-walls of faux-stone concrete blocks, surmounted by sturdy Tuscan columns and a shaped stucco fascia.

On the left side elevation, a shallow, projecting rectangular bay window towards the front contains a tripartite window with all diamond-paned sash and surmounts a one-bay garage door. Two single windows are set towards the back of this elevation on the main floor. The right side elevation displays four slightly asymmetrical windows and has concrete steps accessing the end of the porch.

Well maintained and well preserved, 10 Oakland Street is a small scale yet unusually inventive example of Bungalow design in Lexington. It is notable for its characteristic Bungalow form, stucco cladding, idiosyncratic use of concrete block, carefully-developed porch, varied fenestration, and integral garage.

## HISTORICAL NARRATIVE

*Discuss the history of the building. Explain its associations with local (or state) history. Include uses of the building, and the role(s) the owners/occupants played within the community.*

Part of the Merriam Hill neighborhood, 10 Oakland Street represents the infrequent, early 20<sup>th</sup> century infill on the south slope of the hill. These houses were typically modestly scaled and ornamented, scattered amongst much larger and more elaborate residences. 10 Oakland Street appears to have been built between 1910 and 1918. The first known residents, in 1918, were Samuel E. Brown (1885-1964), an artist with a studio in Boston, and his wife Florence I. The Brown family, which also included two young sons, lived here at least through 1922. Subsequent residents included George Hauman, another artist, and his wife Doris C. (who lived here with a young son from at least 1930 through 1940); Walter W. McCoubrey, who was in the Army, and his wife Mary (1945); and William H. Kilpatrick, a dentist, and his wife Jane (1955 and 1965).

## BIBLIOGRAPHY and/or REFERENCES

Ancestry.com. Massachusetts, Mason Membership Cards, 1733-1990 [database on-line]. Provo, UT, USA: Ancestry.com Operations, Inc., 2013. Original data: Massachusetts Grand Lodge of Masons Membership Cards 1733–1990. New England Historic Genealogical Society, Boston, Massachusetts.

# INVENTORY FORM B CONTINUATION SHEET

LEXINGTON

10 OAKLAND STREET

MASSACHUSETTS HISTORICAL COMMISSION

220 MORRISSEY BOULEVARD, BOSTON, MASSACHUSETTS 02125

Area(s) Form No.

H	1169
---	------

Blue Hill Bay Gallery, Bluehill, Maine. Works by Samuel Brown. <http://www.bluehillbaygallery.com/p/brown.html> Accessed Jul 28, 2015.

Historic maps and atlases: Walling 1853; Beers 1875; Walker 1889; Stadly 1898; Walker 1906; Sanborn 1908, 1918, 1927, 1935, 1935/1950.

Lexington Comprehensive Cultural Resources Survey, Period Summaries. <http://historicsurvey.lexingtonma.gov/index.htm> Accessed Jul 23, 2015.

Lexington Directories: 1899, 1908-09, 1918, 1922, 1934, 1936.

Lexington Historical Commission. Form A, LEX.H, Meriam Hill. Prepared by Lisa Mausolf, 2000.

Lexington List of Persons: 1935, 1945, 1955, 1965.

Massachusetts Historical Commission. "MHC Reconnaissance Survey Town Report: Lexington." 1980.

U.S. Census: 1900, 1920, 1930, 1940.

## SUPPLEMENTARY IMAGES



Front (facade) elevation



Left side elevation