

FORM B - BUILDING

Assessor's number
55/18

USGS Quad
Boston N.

Area(s)

Form Number
1105,1106

Massachusetts Historical Commission



Town Lexington

Place (neighborhood or village) Upper Meriam Hill

Address 8 Oakmount Circle

Historic Name Sherburne & Mary Prescott House

Uses: Present Residential

Original Residential

Date of Construction 1922

Source Lexington Valuation Lists

Style/Form Colonial Revival

Architect/Builder Haven & Hoyt (Lewis Sise), Boston

Exterior Material:

Foundation not visible

Wall/Trim brick

Roof slate

Outbuildings/Secondary Structures

garage/gardeners cottage (1923) - MHC #1106

inground swimming pool

Major Alterations (with dates) 1988 - tore down maid's

porch, added to kitchen, screened porch converted to sunporch

Condition good

Moved no yes Date

Acreage 47,380 SF

Setting early 20th century residential neighborhood

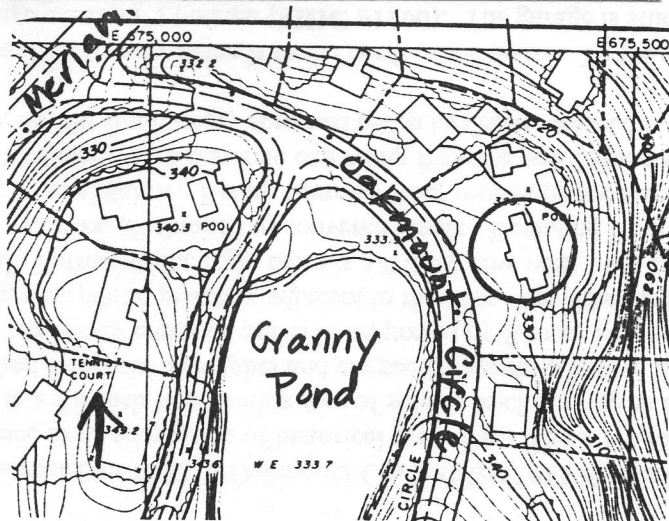

Recorded by Lisa Mausolf

Organization Lexington Historical Commission

Date (month/year) June 2000