

FORM B - BUILDING

AREA 0	FORM NO. 495
-----------	-----------------

MASSACHUSETTS HISTORICAL COMMISSION
294 WASHINGTON STREET, BOSTON, MA 02108



City Lexington

Address 24 Percy Road

Historic Name William E. Page House

(Page-Sherburne House)

Present residential

Original residential

DESCRIPTION:

Year 1896

Source Lexington Minute Man, June 14, 1895

Style Shingle Style

Architect _____

Exterior wall fabric shingles

Outbuildings _____

Major alterations (with dates) _____

Moved _____ Date _____

Approx. acreage 13545 ft.²

Setting Munroe Hill; residential street

developed primarily in the late nineteenth century.

SKETCH MAP

Show property's location in relation to nearest cross streets and/or geographical features. Indicate all buildings between inventoried property and nearest intersection. Indicate north.

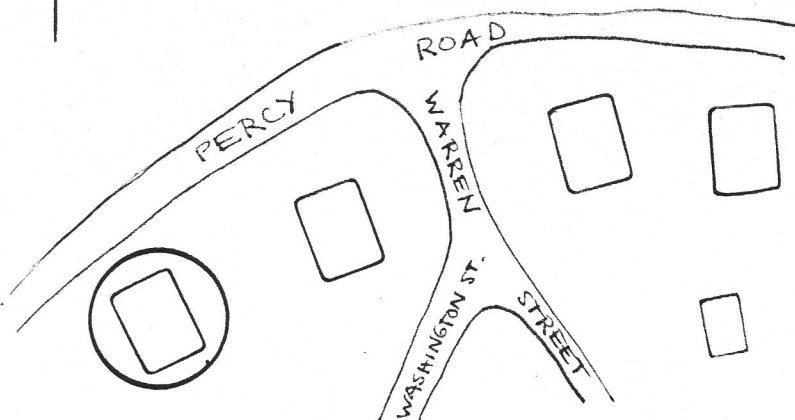

Recorded by Anne Grady

Organization Lexington Historical Commission

Date March, 1984

(Staple additional sheets here)