

FORM B – BUILDING

MASSACHUSETTS HISTORICAL COMMISSION
MASSACHUSETTS ARCHIVES BUILDING
220 MORRISSEY BOULEVARD
BOSTON, MASSACHUSETTS 02125

Assessor's Number USGS Quad Area(s) Form Number

006400142A Boston N. 760, 761

Town Lexington

Place (neighborhood or village)

Address 23 Revere St.

Historic Name Benjamin F. Gleason House

Uses: Present Residential

Original Residential

Date of Construction 1851

Source Tuttle list

Style/Form Italianate

Architect/Builder David A. Tuttle

Exterior Material:

Foundation Granite

Wall/Trim Wood Clapboard

Roof Asphalt Shingle

Outbuildings/Secondary Structures Barn

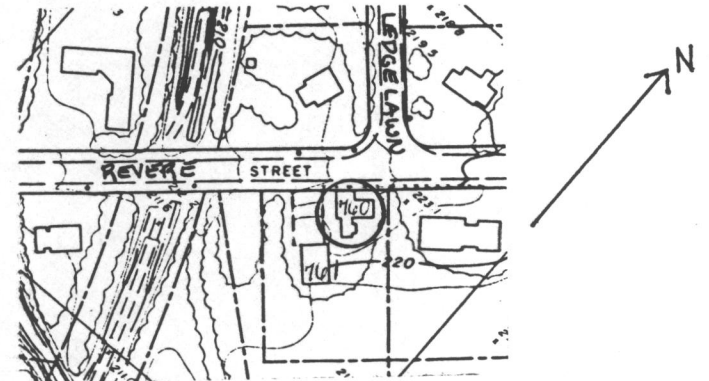

Major Alterations (with dates)

Side addition (date unknown)

Condition Good

Moved no yes Date

Acreage 0.5 A.

Setting Very close to a fairly busy street and near the bikepath (formerly the railroad tracks)

Recorded by Nancy S. Seasholes

Organization Lexington Historical Commission

Date (month / year) April 1998