

FORM B - BUILDING

Assessor's number  
57/92

USGS Quad  
Boston N.

Area(s)

Form Number  
1119



Town Lexington  
Place (neighborhood or village) North Lexington

Address 12 Shirley Street  
Historic Name Custance-Morse House

Uses: Present Residential  
Original Residential

Date of Construction 1917

Source Lexington Valuation List

Style/Form Craftsman

Architect/Builder Custance Brothers?

Exterior Material:

Foundation rubble

Wall/Trim wood shingles

Roof asphalt shingle

Outbuildings/Secondary Structures

garage

Major Alterations (with dates) none

Condition good

Moved  no  yes Date

Acreage 7873 SF

Setting mixed early 20th century residential  
neighborhood

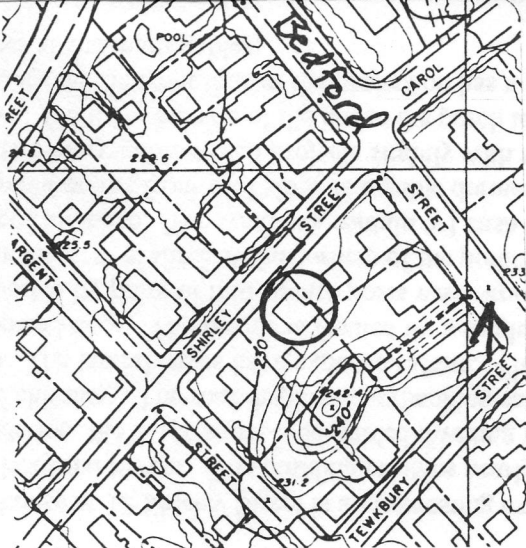

Recorded by Lisa Mausolf

Organization Lexington Historical Commission

Date (month/year) June 2000