

FORM B - BUILDING

Assessor's number
57-94

USGS Quad
Boston N.

Area(s)

Form Number
1120



Town Lexington

Place (neighborhood or village)

Address 24 Shirley Street

Historic Name Walter & Mary Spellman House

Uses: Present Residential

Original Residential

Date of Construction c.1900 (by 1906)

Source Directories, List of Persons

Style/Form Queen Anne

Architect/Builder unknown

Exterior Material:

Foundation Rubble

Wall/Trim Wood Clapboards, Wood shingles

Roof Asphalt Shingle

Outbuildings/Secondary Structures

none

Major Alterations (with dates) date? - turned balustrade

Condition good

Moved no yes Date

Acreage 7424 SF

Setting mixed 20th century residential neighborhood
off Bedford Street

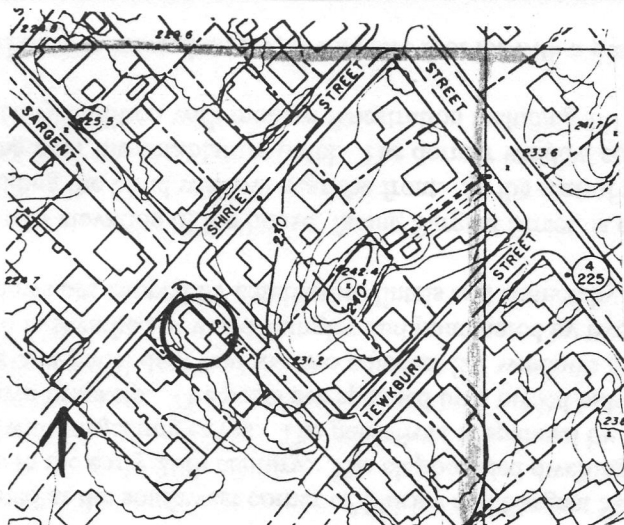

Recorded by Lisa Mausolf

Organization Lexington Historical Commission

Date (month/year) January 2000