

FORM B - BUILDING

Assessor's number
56/112

USGS Quad
Boston N.

Area(s)

Form Number
1125

Massachusetts Historical Commission



Town Lexington

Place (neighborhood or village) Upper Meriam Hill

Address 38 Somerset Road

Historic Name William and Marjory Greeley House

Uses: Present Residential

Original Residential

Date of Construction 1912-1913

Source Lexington Valuation Lists

Style/Form Colonial Revival

Architect/Builder William R. Greeley

Exterior Material:

Foundation brick

Wall/Trim brick

Roof wood shingle

Outbuildings/Secondary Structures

none

Major Alterations (with dates) 1972 - garage under deck

Condition good

Moved no yes Date

Acreage 31,000 SF

Setting early 20th century residential neighborhood

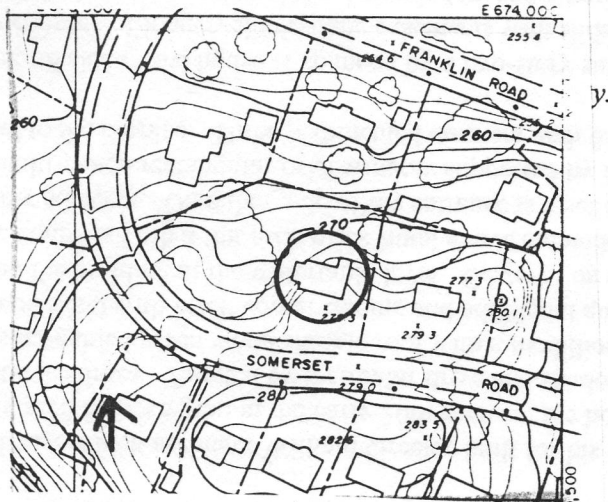

Recorded by Lisa Mausolf

Organization Lexington Historical Commission

Date (month/year) May 2000