

FORM B - BUILDING

Assessor's number
56/114A

USGS Quad
Boston N.

Area(s)

Form Number
1132



Town Lexington

Place (neighborhood or village) Upper Meriam Hill

Address 44 Somerset Road

Historic Name Lawrence & Olive Burnham House

Uses: Present Residential

Original Residential

Date of Construction 1927

Source Lexington Valuation Lists

Style/Form Dutch Colonial

Architect/Builder unknown

Exterior Material:

Foundation brick

Wall/Trim brick/wood shingles

Roof asphalt shingle

Outbuildings/Secondary Structures

none

Major Alterations (with dates) 1988-open porch on north side, rear addition and built-in garage

Condition good

Moved no yes Date

Acres 14,004 SF

Setting early 20th century residential neighborhood

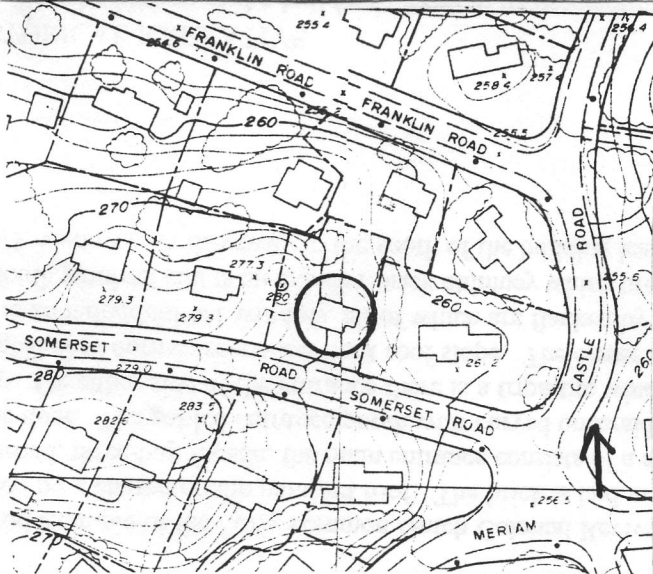

Recorded by Lisa Mausolf

Organization Lexington Historical Commission

Date (month/year) May 2000