

FORM B - BUILDING

AREA	FORM NO.
H	392



Town Lexington
 Address 6 Stetson, Street
 Historic Name Edward Porter Merriam
 House _____
 Use: Present residential
 Original residential

DESCRIPTION:

Date 1894
 Source Lexington Minute Man, Mar. 16, 1894
 Style Colonial Revival/Queen Anne
 Architect John May of Magnolia (arch. + builder)
 Exterior wall fabric shingles
 Outbuildings garage
 Major alterations (with dates) garage (1946); piazza roofed over (1954)
 Moved _____ Date _____
 Approx. acreage 0.4 acre (18,641')
 Setting A prominent site near the top of Meriam Hill on a residential street developed primarily in the late nineteenth century.

Draw map showing property's location in relation to nearest cross streets and other buildings or geographical features. Indicate north.

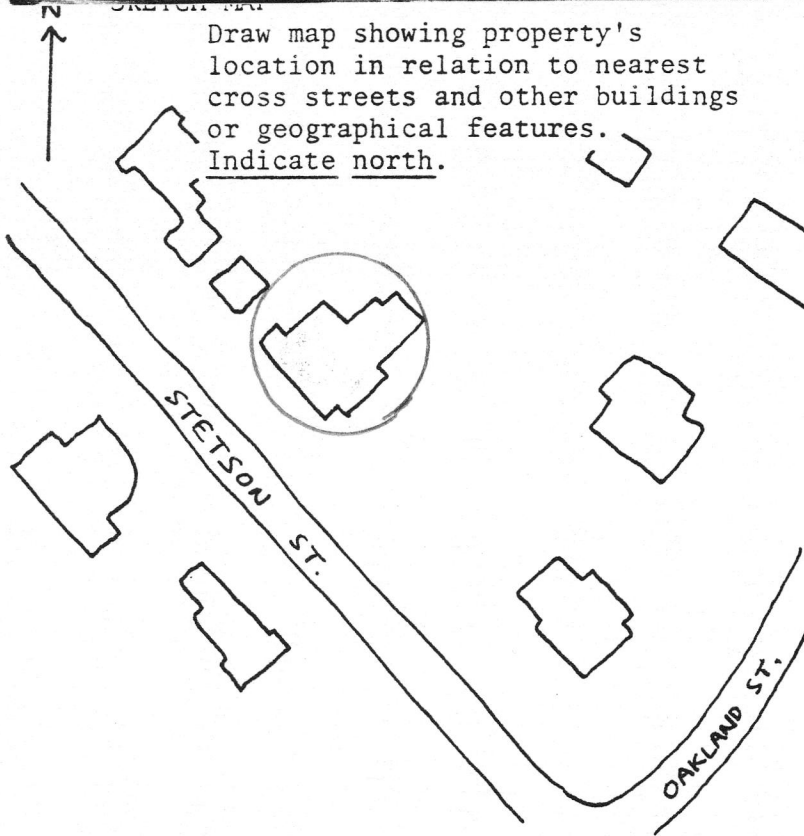

Recorded by Anne Grady
 Organization Lexington Historical Commission
 Date March, 1984

(Staple additional sheets here)