

FORM B - BUILDING

AREA F	FORM NO. 306
-----------	-----------------

MASSACHUSETTS HISTORICAL COMMISSION
294 WASHINGTON STREET, BOSTON, MA 02108



City Lexington

Address 47 Woburn Street

Historic Name Keefe House

Present Use residential

Original Use residential

DESCRIPTION:

Estimated Date c. 1895

Source 1898 map

Style Queen Anne late nineteenth century Vernacular

Architect _____

Exterior wall fabric asbestos shingles

Outbuildings _____

Major alterations (with dates) truncated;
rear ells

Moved _____ Date _____

Approx. acreage 3200 ft.²

Setting On a busy street close to
similar nineteenth century houses.

SKETCH MAP

Show property's location in relation to nearest cross streets and/or geographical features. Indicate all buildings between inventoried property and nearest intersection. Indicate north.

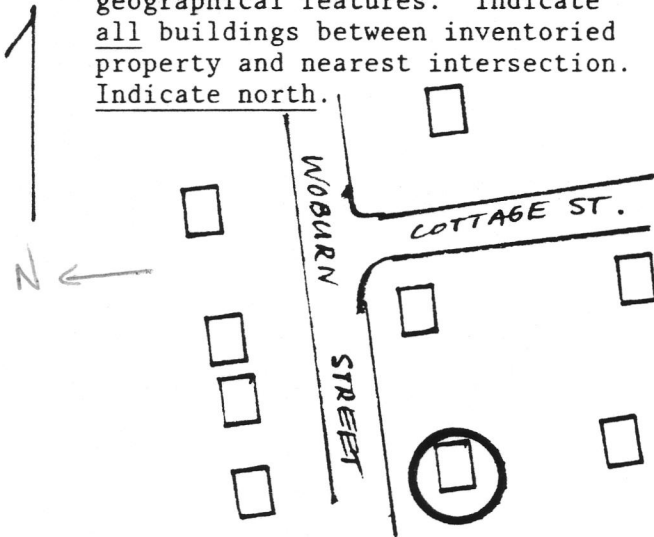

Recorded by Nancy S. Seasholes

Organization Lexington Historical Commission

Date April, 1984

(Staple additional sheets here)

ARCHITECTURAL SIGNIFICANCE (Describe important architectural features and
evaluate in terms of other buildings within the community.)

See area form F.

HISTORICAL SIGNIFICANCE (Explain the role owners played in local or state
history and how the building relates to the development of the community.)

See area form F.

BIBLIOGRAPHY and/or REFERENCES (name of publication, author, date and publisher)