

FORM B - BUILDING

AREA	FORM NO.
F	315

MASSACHUSETTS HISTORICAL COMMISSION
 294 WASHINGTON STREET, BOSTON, MA 02108



own Lexington

Address 65 Woburn Street

Historic Name Welsh House

Use: Present residential

Original residential

DESCRIPTION:

Date c. 1855

Source 1852, 1876 maps

SKETCH MAP

Show property's location in relation to nearest cross streets and/or geographical features. Indicate all buildings between inventoried property and nearest intersection. Indicate north.

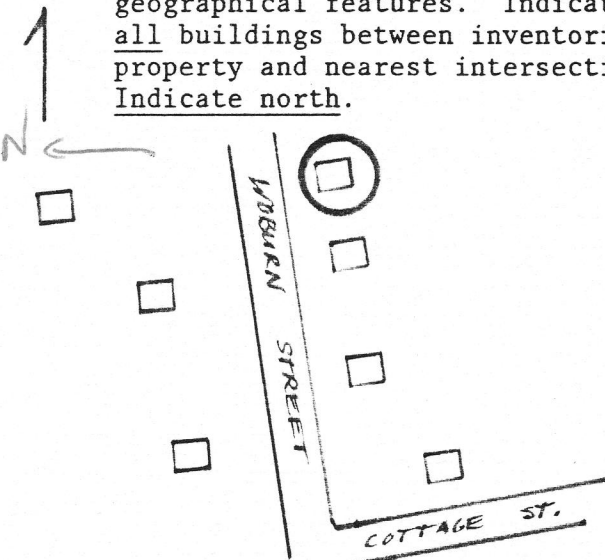

Style Workers Cottage Italianate

Architect _____

Exterior wall fabric clapboard

Outbuildings _____

Major alterations (with dates) large

two-story rear ell (before 1889), with

chimney and ell on south

Moved _____ Date _____

Approx. acreage 5445 ft.²

Setting Close to busy street and other

similar nineteenth century houses.

Recorded by Nancy S. Seasholes

Organization Lexington Historical Commission

Date April, 1984

(Staple additional sheets here)